

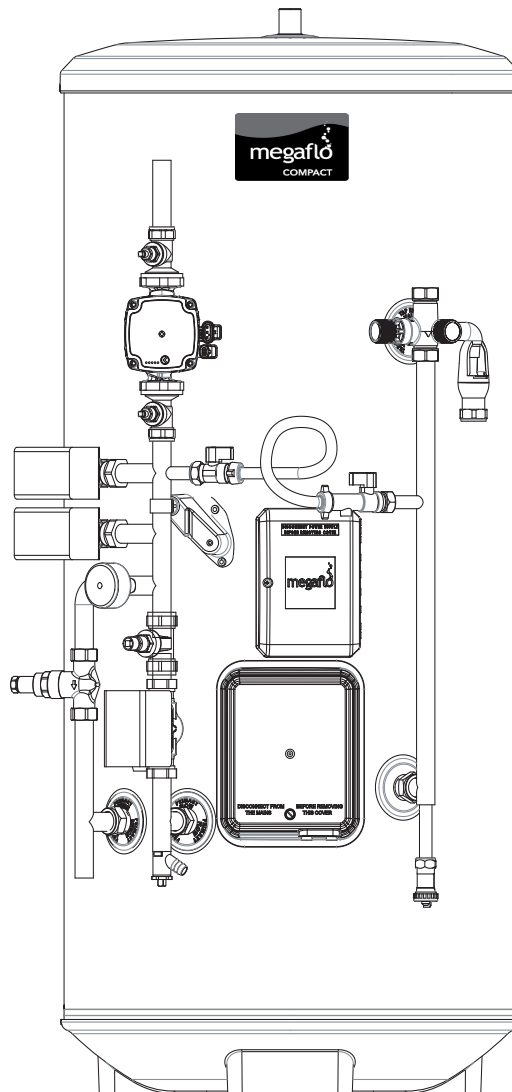

Megaflow Compact Systemfit Unvented Indirect Hot Water Cylinders



Important

Please read & understand all these instructions before commencing installation.
Please leave this manual with the customer for future reference

Contents

1. Introduction	3
1.1 General	3
1.2 Symbols used	3
1.3 Abbreviations	3
1.4 Liabilities	3
2. Safety	4
2.1 General safety warnings	4
3. Technical specifications	5
3.1 Technical data	5
3.2 Dimensions	6
4. Description of the product	7
4.1 General description	7
4.2 Operation principle	7
4.3 Main connections	7
4.4 Standard delivery	7
5. Before installation	7
5.1 Installation regulations	7
5.2 Installation requirements	7
5.3 Choice of location	8
5.4 Transport	8
6. Installation	9
6.1 General	9
6.2 Water connections	10
6.3 Electrical connections	17
6.4 Access to appliance control housing	18
6.5 Filling the installation	19
7. Commissioning	20
7.1 General	20
7.2 Checklist before commissioning	20
7.3 Commissioning procedure	20
7.4 Circulation pump set up	21
8. Operation	24
8.1 General	24
9. Maintenance	25
9.1 General	25
9.2 Standard inspection & maintenance operations	25
10. Troubleshooting	26
10.1 Fault finding	26
11. Decommissioning	27
11.1 Decommissioning procedure	27
12.1 Spare parts list	28
Benchmark checklist	32
Commissioning & service records	33
Warranty	35



THE BENCHMARK SCHEME

Benchmark places responsibilities on both manufacturers and installers. The purpose is to ensure that customers are provided with the correct equipment for their needs, that it is installed, commissioned and serviced in accordance with the manufacturer's instructions by competent persons and that it meets the requirements of the appropriate Building Regulations and relevant electrical qualifications. The Benchmark Checklist can be used to demonstrate compliance with Building Regulations and should be provided to the customer for future reference. Installers are required to carry out installation, commissioning and servicing work in accordance with the Benchmark Code of Practice which is available from the Heating and Hotwater Industry Council who manage and promote the Scheme. Visit www.centralheating.co.uk for more information.

1. Introduction

1.1 General

The following instructions are offered as a guide to the user and installer.

The installation must be carried out by a competent plumbing and electrical installer in accordance with Building Regulation G3 (England and Wales), Technical Standard P3 (Scotland) or Building Regulation P5 (Northern Ireland) and the Water Fitting Regulations (England and Wales) or Water Byelaws (Scotland).

1.2 Symbols used

In these instructions, various risk levels are employed to draw the user's attention to particular information. In doing so we wish to safeguard the user, avoid hazards and guarantee the correct operation of the appliance.



DANGER

Risk of a dangerous situation causing serious physical injury.



WARNING

Risk of dangerous situation causing slight physical injury.



CAUTION

Risk of material damage.



Signals important information.

1.3 Abbreviations

- ▶ T&P - Temperature & Pressure relief valve
- ▶ PRV - Pressure Reducing Valve
- ▶ ERV - Expansion relief valve

1.4 Liabilities

Manufacturers liability

Our products are manufactured in compliance with the requirements of the various applicable European Directives.

This appliance complies with the requirements of the CE marking directive.

In the interest of UK customers, we are continuously endeavouring to make improvements in product quality. All the specifications stated in this document are therefore subject to change without notice.

Our liability as the manufacturer may not be invoked in the following cases:

- ▶ Failure to abide by the instructions on using the appliance.
- ▶ Faulty or insufficient maintenance of the appliance.
- ▶ Failure to abide by the instructions on installing the product.

Installer's liability

The installer is responsible for the installation and the commissioning of the appliance. The installer must respect the following instructions:

- ▶ Read and follow the instructions given in the manuals provided with the appliance.
- ▶ Carry out installation in compliance with the prevailing legislation and standards.
- ▶ Perform the initial start up and carry out any checks necessary.
- ▶ Complete the commissioning checklist.
- ▶ Explain the installation to the user.
- ▶ If maintenance is necessary, warn the user of the obligation to check the appliance and maintain it in good working order.
- ▶ Give all the instruction manuals to the user.

Users liability

To guarantee optimum operation of the appliance, the user must respect the following instructions:

- ▶ Read and follow the instructions given in the manuals provided with the appliance.
- ▶ Call on qualified professionals to carry out installation and initial start up.
- ▶ Get your installer to explain your installation to you.
- ▶ Have your required checks and services done.
- ▶ Keep the instruction manuals in good condition and close to the appliance.



This appliance can be used by children aged from 8 years and above and persons with reduced physical sensory or mental capabilities or lack of experience and knowledge if they have been given supervision or instruction concerning use of the appliance in a safe way and understand the hazards involved. Children shall not play with the appliance. Cleaning and user maintenance shall not be made by children without supervision.

Children must be supervised to ensure they do not play with the appliance.



- Water may drip from the discharge pipe of the pressure-relief device and this pipe must be left open to the atmosphere; (see page 16 for more details)

-The pressure-relief device is to be operated regularly to remove lime deposits and to verify that it is not blocked; (see page 25 for more details)

- How hot water can be drained. (see page 25 for more details)

- The type or characteristics of the pressure-relief device and how to connect it; (see Figure 3, page 9 for details and Figure 7, page 11)

- A discharge pipe connected to the pressure-relief device is to be installed in a continuously downward direction and in frost free environment; (see Figure 11, page 16 for details)

Details on how to set the temperature controls for both immersion heaters and boiler controls can be found in section "Installation Instructions Figure 16, page 20.

2. Safety

2.1 General safety warnings



DANGER

This cylinder is unvented and as such becomes pressurised when in operation. The combination of pressurisation and hot water could lead to serious physical injury if the safety instructions in this manual are not adhered to.



WARNING

- ▶ Only competent persons having received adequate training are permitted to work on the appliance and the installation.
- ▶ Do not tamper with any of the safety valves or controls supplied with the cylinder.
- ▶ Before any work, switch off the mains supply to the appliance and the water mains.
- ▶ Do not switch on if there is a possibility that the water in the cylinder is frozen.



CAUTION

Do not operate immersion heaters until the cylinder has been filled with water.



WARNING

When handling the unit, take appropriate precautions for the weight of the unit. Weights can be found in section 3, table 1, page 5.



CAUTION

Annual maintenance is recommended by a competent person.



WARNING TO USER

- ▶ If water discharges from the Temperature/ Pressure Relief Valve on the cylinder shut down the boiler/immersion heaters. Do not turn off any water supply. Contact a competent installer for unvented water heaters to check the system.
- ▶ Do not tamper with any of the safety valves fitted to the system. If a fault is suspected contact a competent installer.
- ▶ DO NOT bypass the thermal cut-out(s) in any circumstances.

3. Technical specifications

3.1 Technical data:

		2sf	4sf	6sf	8sf
Max direct kW rating		3	3	3	3
Immersion heat up times (Btm immersion, 3kW)		139	167	179	208
Coil surface area (m ²)		0.51			
Coil heat up times	15l/min	33.1	40.1	43.0	45.1
	30l/min	26.9	30.2	34.8	37.7
	45l/min	25.0	28.8	32.3	34.2
Coil rating (kW) ²	15l/min	13.1	12.7	13.7	14.3
	30l/min	16.3	16.3	17.1	17.3
	45l/min	17.6	17.7	18.8	19.1
Pressure drop through coil	15l/min	0.004 MPa (0.04 Bar)			
	30l/min	0.013 MPa (0.13 Bar)			
	45l/min	0.031 MPa (0.31 Bar)			
Heat loss (kW/24hrs)		1.58	1.59	1.82	1.97
Weight empty (kg)		43	48	52	55
Weight full (kg) ¹		180	203	230	250
Volume (Litres) ¹		137	155	178	195
Mixed water delivery to 40°C ¹		168	188	218	238
Max mains pressure		1.6 MPa (16 Bar)			
Max design pressure		0.8 MPa (8 Bar)			
Operating pressure/PRV set pressure		0.3 MPa (3 Bar)			
Max primary pressure ³		1.0 MPa (10 Bar)			
Expansion relief valve setting		0.8 MPa (8 Bar)			
T&P valve setting		90°C +/- 5°C/1.0 MPa (10 Bar)			
T&P Part number		7034796			
Immersion heater electrical rating		3.0 kW@240V/2.8kW@230V ~			

Table 1: Technical data - Indirect

Notes:

1. Indirect cylinders tested in accordance with BS EN 12897:2006.
2. Heat up time from cold through 45°C, based on a flow temperature of 80°C +/- 2°C & normal volume.

Model(s)	2sf	4sf	6sf	8sf
Energy efficiency class	C	C	C	C
Storage volumes V in Litres	137	155	178	195
Standing loss in W	65.8	66.3	75.8	82.1

Table 2: Technical parameters in accordance with European Commission regulations 814/2013 and 812/2013

3.2 Dimensions and connections

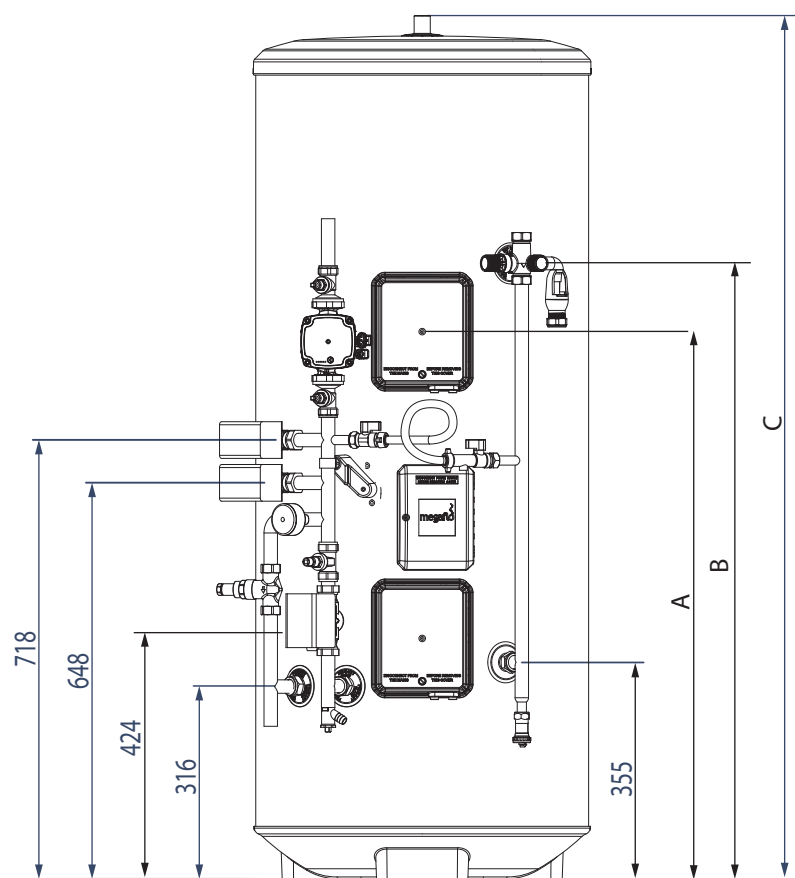
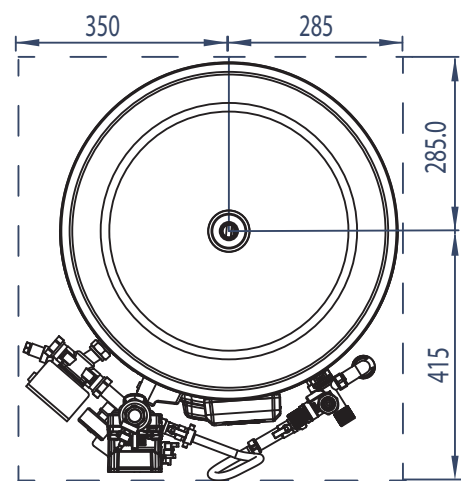

Figure 1: General dimensions - SystemFit



Size	DIMENSIONS (mm)		
	A	B	C
2sf	N/A	728	1130
4sf	N/A	883	1256
6sf	N/A	1008	1413
8sf	900	1084	1515

Table 3: General dimensions table - SystemFit

Danfoss TP9000 Programmable Thermostat with timed Domestic Hot Water (DHW) control:

Programmer dimensions: 135mm (W) x 88mm (H) x 32mm (D)
Room temperature sensor dimensions: 60mm (W) x 45mm (H) x 21mm (D)
Power supply: 220V/240V ac, 50Hz
Switch action 2 x SPDT, Type 1B. Switch rating 220/240V ac, 50/60Hz, 3(1)A
Power reserve: minimum 24 hours
Memory back up retained for life of product
Enclosure rating: IP30
Control temperature range: selectable 5 to 30°C
Holiday mode with room temperature setback
Timing accuracy: +/- 1 minute/month
Maximum ambient temperature: 45°C

Danfoss TP5000 programmable thermostat:

Programmer dimensions: 110mm (W) x 88mm (H) x 32mm (D)
Power supply: 2xAA / MN1500 / LR6 alkaline batteries (supplied)
Switch type: SPDT
Memory retention: 1 minute during battery change
Temperature range: off, 5-30°C
Maximum ambient temperature: 45°C

Honeywell 2 Port Motorised Valves:

Model No.: V4043H
Voltage rating: 230V ac, 50HZ
Power consumption: 6W
Primary water temperature range: 5 to 88°C
Maximum ambient temperature: 52°C

Automatic Differential By-pass Valve:

Model No.: RWC DIFF 200 005
Setting range: 0 to 0.05 MPa (0 to 0.5 bar) differential pressure
Maximum primary water temperature: 110°C
Maximum operating pressure 1.0MPa (10 bar)

Primary Circulating Pump:

Model No.: Grundfos UPM3 Auto L 25-70 130
Working pressure: 1 MPa (10 bar) max.
Voltage rating: 230V ac, 50Hz
Starting capacitor: 2 µF
Enclosure rating: IP42

4. Description of the product

4.1 General description

This appliance is a purpose designed unvented water heater. The appliance has a stainless steel inner vessel, which ensures an excellent standard of corrosion resistance. The outer casing is a combination of resilient thermoplastic mouldings and pre-coated steel. All products are insulated with CFC free polyurethane foam to give good heat loss protection.

The appliance is supplied complete with all the necessary safety and control devices needed to allow connection to the cold water mains. All these components are preset and should not be tampered with.

4.2 Operation principle

The appliance is used to heat and store hot water for use in domestic applications.

The water can be heated indirectly through a coil in the unit using an indirect heat source, or directly via back up immersion heater.

4.3 Main connections

See Figure 6 : Main connections on page 9

4.4 Standard delivery

The delivery includes:

- ▶ Cylinder
- ▶ Factory fitted
 - ▶ Immersion heater and thermal controls
 - ▶ Combination Temperature and Pressure Relief Valve (set at 90°C / 1 Mpa (10bar) and Expansion relief valve
 - ▶ Indirect thermostat and thermal cut-out
 - ▶ Tundish
 - ▶ Wiring centre
 - ▶ 3 x 2 Port motorised valve
 - ▶ Primary circulation pump
 - ▶ Lock shield flow balancing valve
 - ▶ Differential bypass valve
 - ▶ Filling Loop
 - ▶ Primary circuit pressure gauge
 - ▶ Drain valve (with quarter turn lever)
- ▶ Literature pack
 - ▶ Instructions (inc benchmark commissioning checklist & service record)
 - ▶ Warranty card
- ▶ 3 bar pressure reducing valve (incorporating strainer)
- ▶ Automatic air vent
- ▶ Isolation valve
- ▶ CH/DHW programmer and room temperature sensor
- ▶ Primary circuit expansion vessel (including wall mounting bracket)
- ▶ CH second zone room thermostat/programmer
- ▶ Mixing valve
- ▶ Mixing valve connection pipe

Check all components are supplied in the pack and advise your supplier if any are missing

5. Before installation

5.1 Installation regulations



WARNING

Installation of the appliance must be carried out by a qualified engineer in accordance with prevailing and national regulations as listed below.

- ▶ Building Regulations G3
- ▶ The Building Standards (Scotland)
- ▶ The Building Regulations (Northern Ireland)
- ▶ I.E.E Electrical Regs
- ▶ UK Water Regulations

5.2 Installation requirements

Water supply

In an unvented system the pressure and flowrate is directly related to the incoming water supply. For this reason it is recommended that the maximum water demand is assessed and the water supply checked to ensure this demand can be satisfactorily met.

- ▶ We suggest the minimum supply requirements should be 0.15MPa (1.5 bar) pressure and 20 litres per minute flow rate. However, at these values outlet flow rates may be poor if several outlets are used simultaneously.
- ▶ A 22mm cold water supply is recommended, however, if a smaller supply exists, which provides sufficient flow, this may be used (although more flow noise may be experienced).
- ▶ The higher the available pressure and flow rate the better the system performance.
- ▶ See table 1 on page 5 for appliance operating pressures. This is controlled by the Pressure Reducing Valve.
- ▶ The water supply must be of wholesome water quality (Fluid Category 1 as defined by the Water Supply Regulations 1999).

Outlet/terminal fittings (taps, etc.)

- ▶ The appliance can be used with most types of terminal fittings.
- ▶ Outlets situated higher than the appliance will give outlet pressures lower than that at the appliance, a 10m height difference will result in a 1 bar pressure reduction at the outlet.
- ▶ All fittings, pipework and connections must have a rated pressure of at least 8 bar at 80°C.

Limitations

The appliance should not be used in association with any of the following:

- ▶ Solid fuel boilers or any other boiler in which the energy input is not under effective thermostatic control, unless additional and appropriate safety measures are installed.
- ▶ Ascending spray type bidets or any other class 1 back syphonage risk requiring that a type A air gap be employed.
- ▶ Steam heating plants unless additional and appropriate safety devices are installed.
- ▶ Situations where maintenance is likely to be neglected or safety devices tampered with.
- ▶ Water supplies that have either inadequate pressure or where the supply may be intermittent.
- ▶ Situations where it is not possible to safely pipe away any discharge from the safety valves.
- ▶ In areas where the water consistently contains a high proportion of solids, e.g. suspended matter that could block the strainer, unless adequate filtration can be ensured.
- ▶ In areas where the water supply contains chloride levels that exceed 250mg/l.

5.3 Choice of location

The appliance must be vertically floor mounted. Although location is not critical, the following points should be considered:

- ▶ The appliance should be sited to ensure minimum dead leg distances, particularly to the point of most frequent use.
- ▶ Avoid siting where extreme cold temperatures will be experienced. All exposed pipe work should be insulated.
- ▶ The discharge pipework from the safety valves must have minimum fall of 1:200 from the appliance and terminate in a safe and visible position, as per G3 requirements.
- ▶ Access to associated controls and immersion heaters must be available for the servicing and maintenance of the system. Where these controls are installed against a wall a minimum distance of 250mm must be left.
- ▶ Ensure that the floor area for the appliance is level and capable of permanently supporting the weight when full of water (see table 1, page 5 for weights).
- ▶ The tundish should be installed away from electrical components.

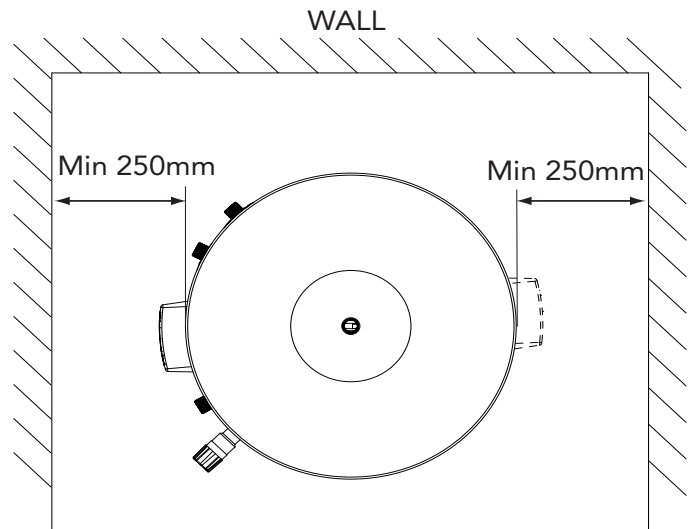

Figure 2 Siting the appliance

5.4 Transport

- ▶ Prior to installation the appliance should be stored and transported in an area free from excessive damp or humidity. The appliance should be stored in a frost free environment. The support surface must be capable of supporting the packaged weight of the appliance, the packaged weights are displayed on the carton label.
- ▶ Please take care when handling a packaged appliance. The units are heavy and must only be moved manually using safe working practices. The package weights of each unit are displayed on the carton label.
- ▶ Take note of the unit weights when deciding on a safe lifting method. DO NOT use the factory fitted T&P/Expansion Relief Valve or pipe work assemblies to lift or manoeuvre the unit.

6. Installation

6.1 General

After reading the previous sections in this booklet and choosing a suitable location for the appliance, please install, paying attention to the following water, electrical and commissioning sections.

Boiler selection

- ▶ The boiler should have a control thermostat and non self-resetting thermal cut-out and be compatible with unvented storage water heaters.

- ▶ Should be a sealed system - maximum primary pressure 3 bar.
- ▶ It is recommended that the automatic air vent supplied is incorporated in the primary return pipework close to the unvented system.
- ▶ The boiler cannot be vented through the appliance.

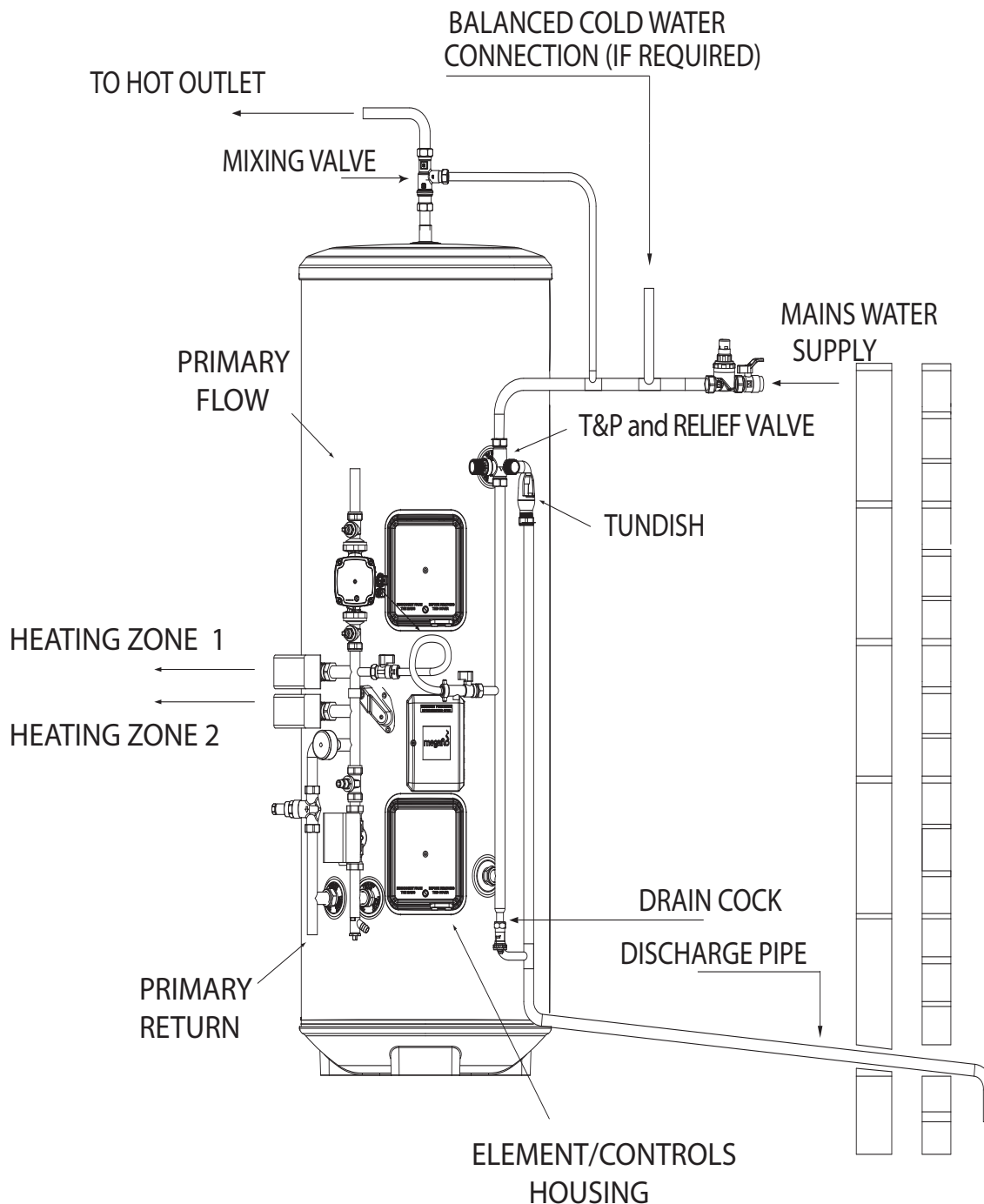

Figure 3: Typical installation schematic (not to scale)

6.2 Water connections



WARNING

- ▶ Under no circumstances should the factory fitted Temperature/Pressure Relief Valve be removed other than by a competent person. To do so will invalidate any warranty or claim.
- ▶ The cold water controls **MUST** be fitted on the mains water supply to the appliance.
- ▶ No control or safety valves should be tampered with or used for any other purpose.
- ▶ The discharge pipe should not be blocked or used for any other purpose.
- ▶ The tundish should not be located adjacent to any electrical components.
- ▶ The mixing valve supplied is factory pre-set to give a water temperature of approx 55°C. Do not dismantle or attempt to adjust

Refer to the installation schematic (fig 8, page 12) for details on the pipework layout. Specific details for the discharge pipework layout is also provided in figure 11 on page 16.

- ▶ The connection points to the heating system are in 22mm O/D copper pipe for 2sf, 4sf, 6sf, and 8sf units.
- ▶ All pipe fittings are made via 22mm compression fittings directly to the unit (nuts and olives supplied).
- ▶ Solder fittings can be used, but extreme care must be taken to ensure the plastic coating of the unit casing is not damaged by heat.
- ▶ Push fit type fittings can be used for connection to the copper pipes.
- ▶ The cold water inlet control kit supplied with the unvented unit incorporates a full flow isolating valve which will enable the unvented water heater to be isolated from the mains supply for maintenance or servicing..
- ▶ It is recommended that the outlet point of the drain pipework be at least 1 metre below the level of the base of the appliance (this can be achieved by attaching a hose to the drain tap outlet spigot).
- ▶ If the 2nd heating zone is not used, it is recommended that for the installer to cap off the valve, using a correctly sized pipe end cap.
- ▶ Hot water distribution pipework should be 22mm pipe with short runs of 15mm pipe to terminal fittings such as sinks and basins. Pipe sizes may vary due to system design

Mixing valve

- ▶ The mixing valve should be installed at the hot outlet point of the appliance using the copper tube supplied, (see figure 4). The mixing valve will reduce the hot water outlet temperature to approx 55°C, further temperature control will be required for outlets such as showers and baths

- ▶ The mixing valve can be installed in any orientation providing the pipe from the tank outlet to the H port of the valve is no more than 500mm long and has no other connections attached
- ▶ Where the application dictates water to be delivered at 60°C, a mixing valve pre-set at 60°C is available as an accessory (see page 28) note the overall mixed water volume would decrease

Cold water control pack



CAUTION

- ▶ Flush supply pipework before connection to remove all flux and debris prior to fitting the inlet controls. Failure to do this may result in irreparable damage to the controls and will invalidate any warranty.

- ▶ The cold water control pack can be connected anywhere on the cold water cylinder supply.
- ▶ The Control pack incorporates the Pressure Reducing Valve and Isolation Valve
- ▶ The pressure setting is set to 0.3Mpa/3.0 bar. It is not adjustable.
- ▶ The valve can be fitted in any orientation to suit the installation as long as the valve is installed with the direction of flow arrows pointing in the correct direction.
- ▶ The Expansion Relief has been incorporated into the T&P Valve for ease of installation
- ▶ No other valves should be placed between the cold pressure reducing valve and the appliance.
- ▶ Where discharge pipework is difficult to attain, the local building control officer from the local council should be sought for advice as this falls under G3 guidelines and is not down to the manufacturer for unvented systems

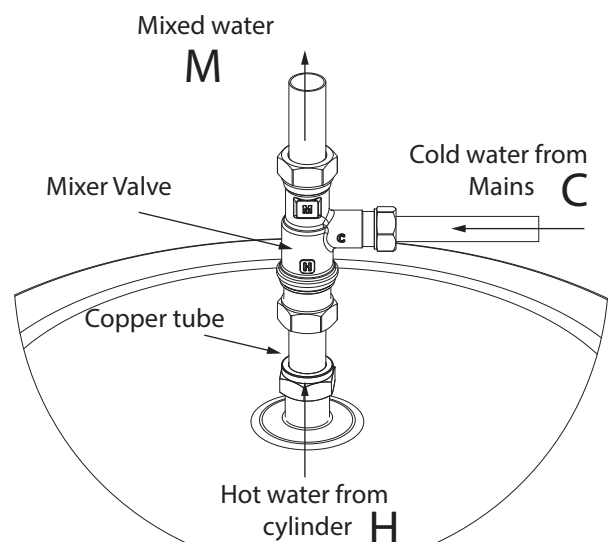

Figure 4: Mixing Valve layout

Primary circuit control

- ▶ It is recommended that the automatic air vent supplied is incorporated in the primary return pipe work close to the unit.
- ▶ Boiler flow temperature should be set to 82° (maximum flow temperature to primary heat exchanger 88°C).
- ▶ See Fig 9 page 13 for example installation schematic, consult boiler manufacturers installation manual for further guidance. Other primary system valves may be required

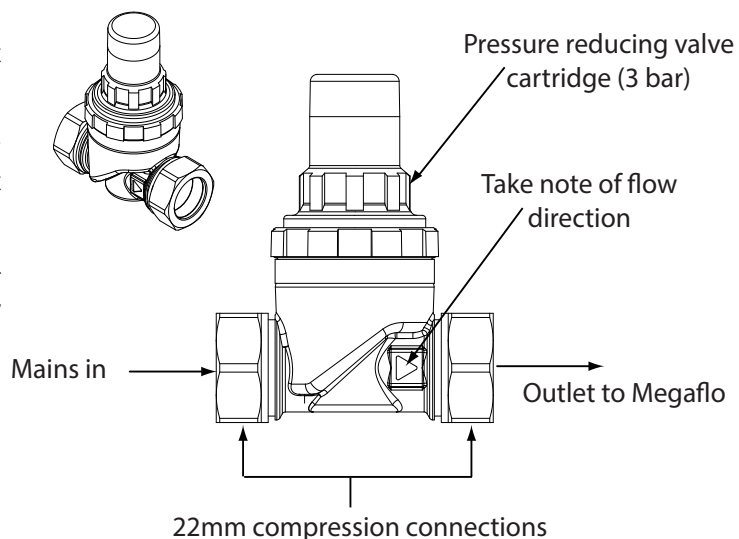

Figure 5: 3 bar Pressure Reducing Valve

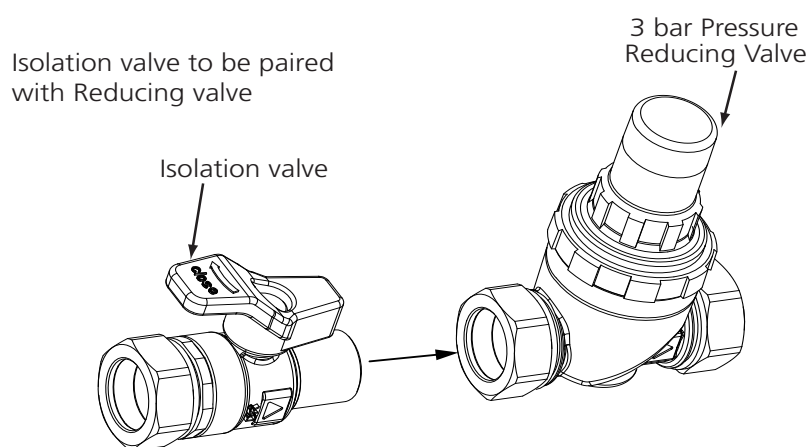

Figure 6: Isolation and 3 bar Pressure Reducing Valves

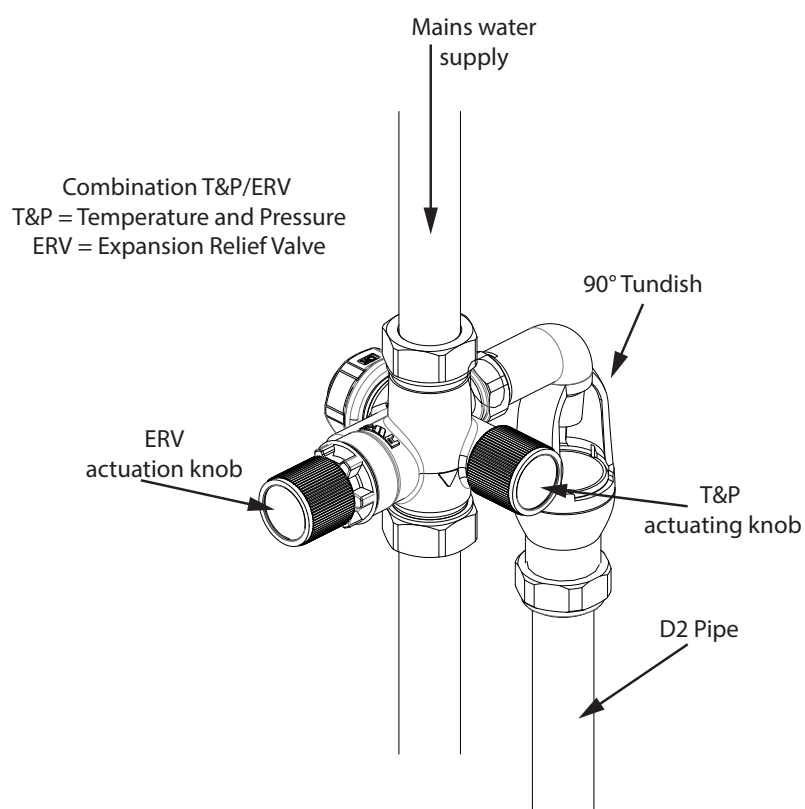
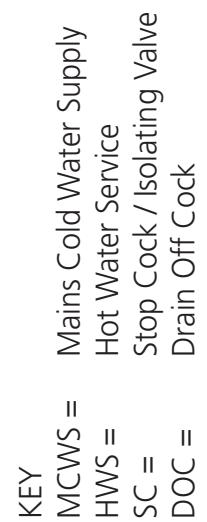

Figure 7: Combination T&P/ERV



12

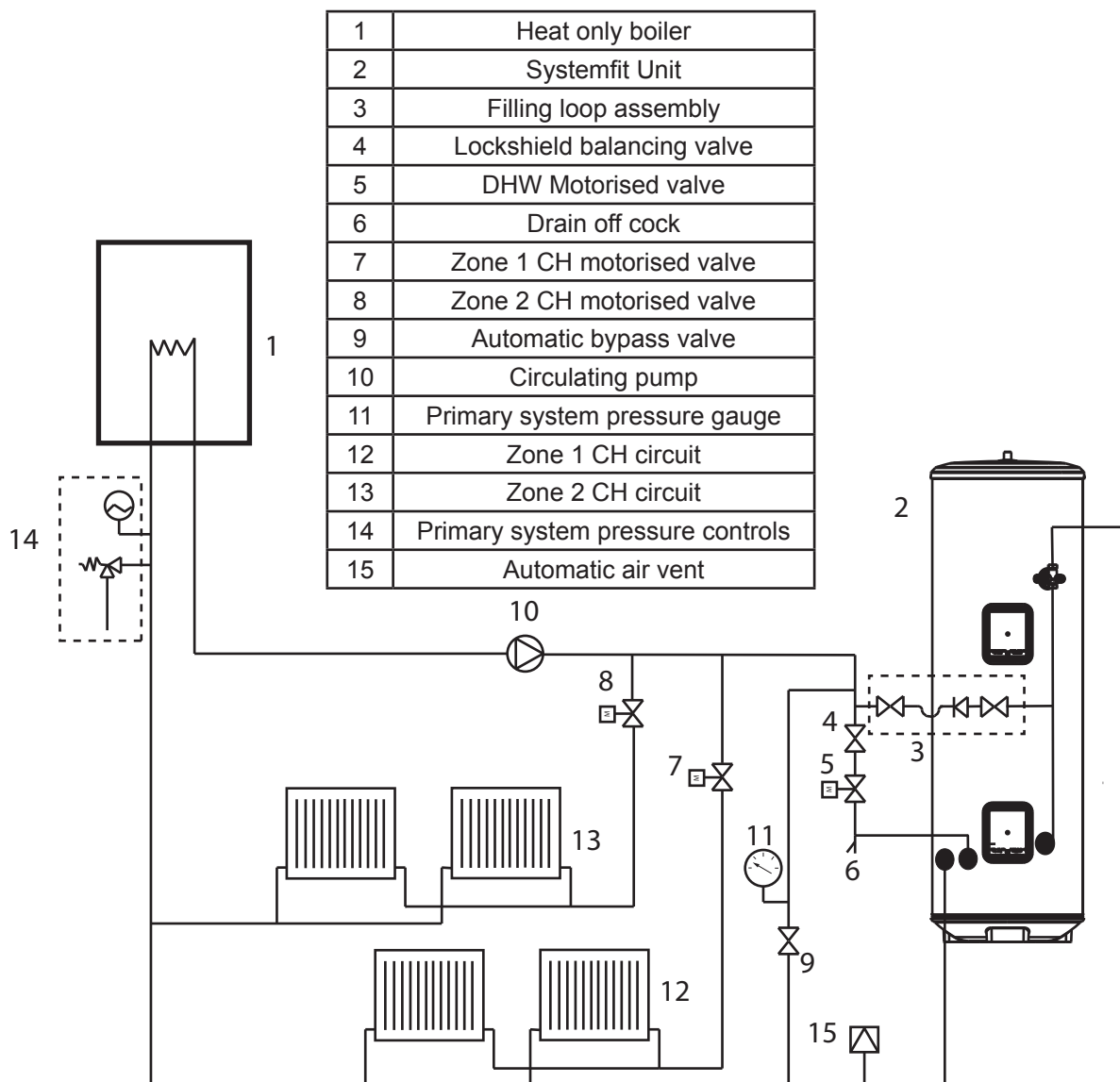

Figure 9: Primary circuit schematic

Secondary circulation

If secondary circulation is required it is recommended that it be connected to the appliance as shown (see fig 10).

- ▶ The secondary return pipe should be in 15mm pipe and incorporate a check valve to prevent backflow.
- ▶ A suitable WRAS approved circulation pump will be required.
- ▶ On large systems, due to the increase in system water content, it may be necessary to fit an additional expansion vessel to the secondary circuit. This should be done if the capacity of the secondary circuit exceeds 10 litres.

Pipe capacity (copper):

15mm O.D. = 0.13 l/m (10 litres = 77m)

22mm O.D. = 0.38 l/m (10 litres = 26m)

28mm O.D. = 0.55 l/m (10 litres = 18m)

Note: Plastic pipe capacities may be reduced due to thicker wall sections.

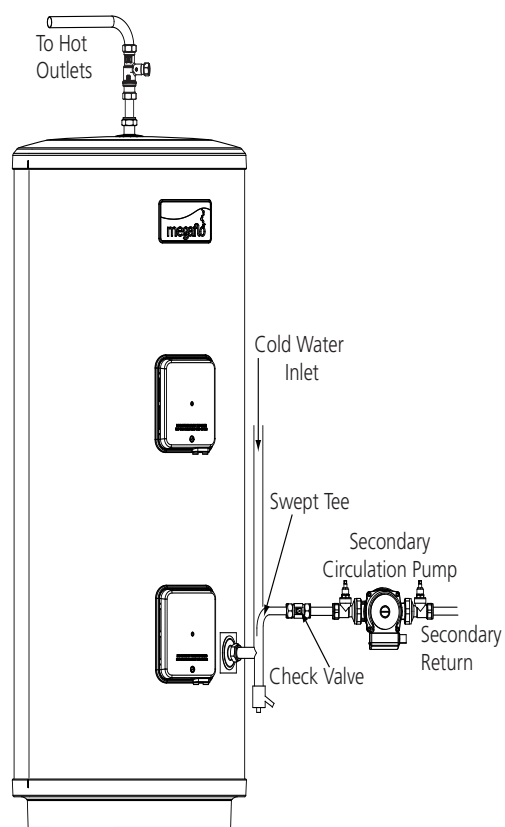

Figure 10: Secondary circulation connection

Discharge

It is a requirement of Building Regulation G3 that any discharge from an unvented system is conveyed to where it is visible, but will not cause danger to persons in or about the building. The tundish and discharge pipes should be fitted in accordance with the requirements and guidance notes of Building Regulation G3. The G3 Requirements and Guidance section 3.50 - 3.63 are reproduced in the following sections of this manual. For discharge pipe arrangements not covered by G3 Guidance advice should be sought from your local Building Control Officer. Any discharge pipe connected to the pressure relief devices (expansion valve and temperature/pressure relief valve) must be installed in a continuously downward direction and in a frost free environment.

Water may drip from the discharge pipe of the pressure relief device. This pipe must be left open to the atmosphere. The pressure relief device is to be operated regularly to remove lime deposits and to verify that it is not blocked.

G3 REQUIREMENT

"...there shall be precautions...to ensure that the hot water discharged from safety devices is safely conveyed to where it is visible but will not cause danger to persons in or about the building."

The following extract is taken from the latest G3 Regulations

Discharge pipes from safety devices

Discharge pipe D1

3.50 Each of the temperature relief valves or combined temperature and pressure relief valves specified in 3.13 or 3.17 should discharge either directly or by way of a manifold via a short length of metal pipe (D1) to a tundish.

3.51 The diameter of discharge pipe (D1) should be not less than the nominal outlet size of the temperature relief valve.

3.52 Where a manifold is used it should be sized to accept and discharge the total discharge from the discharge pipes connected to it.

3.53 Where valves other than the temperature and pressure relief valve from a single unvented hot water system discharge by way of the same manifold that is used by the safety devices, the manifold should be factory fitted as part of the hot water storage system unit or package.

Tundish

3.54 The tundish should be vertical, located in the same space as the unvented hot water storage system and be fitted as close as possible to, and lower than, the valve, with no more than 600mm of pipe between the valve outlet and the tundish (see fig 11).

Note: To comply with the Water Supply (Water Fittings) Regulations, the tundish should incorporate a suitable air gap.

3.55 Any discharge should be visible at the tundish. In addition, where discharges from safety devices may not be apparent, e.g. in dwellings occupied by people with impaired vision or mobility, consideration should be given to the installation of a suitable safety device to warn when discharge takes place, e.g. electronically operated.

Discharge pipe D2

3.56 The discharge pipe (D2) from the tundish should:

- (a) have a vertical section of pipe at least 300mm long below the tundish before any elbows or bends in the pipework (see fig. 11); and
- (b) be installed with a continuous fall thereafter of at least 1 in 200.

3.57 The discharge pipe (D2) should be made of:

- (a) metal; or
- (b) other material that has been demonstrated to be capable of safely withstanding temperatures of the water discharged and is clearly and permanently marked to identify the product and performance standard (e.g. as specified in the relevant part of BS 7291).

3.58 The discharge pipe (D2) should be at least one pipe size larger than the nominal outlet size of the safety device unless its total equivalent hydraulic resistance exceeds that of a straight pipe 9m long, i.e. for discharge pipes between 9m and 18m the equivalent resistance length should be at least two sizes larger than the nominal outlet size of the safety device; between 18 and 27m at least 3 sizes larger, and so on; bends must be taken into account in calculating the flow resistance. See Fig 11, Table 4 and the worked example.

Note: An alternative approach for sizing discharge pipes would be to follow Annex D, section D.2 of BS 6700:2006 Specification for design, installation, testing and maintenance of services supplying water for domestic use within buildings and their curtilages.

3.59 Where a single common discharge pipe serves more than one system, it should be at least one pipe size larger than the largest individual discharge pipe (D2) to be connected.

3.60 The discharge pipe should not be connected to a soil discharge stack unless it can be demonstrated that the soil discharge stack is capable of safely withstanding temperatures of the water discharged, in which case, it should:

- (a) contain a mechanical seal, not incorporating a water trap, which allows water into the branch pipe without allowing foul air from the drain to be ventilated through the tundish;
- (b) be a separate branch pipe with no sanitary appliances connected to it;

- (c) if plastic pipes are used as branch pipes carrying discharge from a safety device they should be either polybutylene (PB) to Class S of BS 7291-2:2006 or cross linked polyethylene (PE-X) to Class S of BS 7291-3:2006; and
- (d) be continuously marked with a warning that no sanitary appliances should be connected to the pipe.

Note:

1. Plastic pipes should be joined and assembled with fittings appropriate to the circumstances in which they are used as set out in BS EN ISO 1043-1.
2. Where pipes cannot be connected to the stack it may be possible to route a dedicated pipe alongside or in close proximity to the discharge stack.

Termination of discharge pipe

3.61 The discharge pipe (D2) from the tundish should terminate in a safe place where there is no risk to persons in the vicinity of the discharge.

3.62 Examples of acceptable discharge arrangements are:

- (a) to a trapped gully with the end of the pipe below a fixed grating and above the water seal;
- (b) downward discharges at low level; i.e. up to 100mm above external surfaces such as car parks, hard standings, grassed areas etc. are acceptable providing that a wire cage or similar guard is positioned to prevent contact, whilst maintaining visibility; and
- (c) discharges at high level: e.g. into a metal hopper and metal downpipe with the end of the discharge pipe clearly visible or onto a roof capable of withstanding high temperature discharges of water and 3m from any plastic guttering system that would collect such discharges.

3.63 The discharge would consist of high temperature water and steam. Asphalt, roofing felt and non-metallic rainwater goods may be damaged by such discharges.

Worked example of discharge pipe sizing

Fig. 11: shows a G1/2 temperature relief valve with a discharge pipe (D2) having 4 No. elbows and length of 7m from the tundish to the point of discharge.

From Table 4:

Maximum resistance allowed for a straight length of 22mm copper discharge pipe (D2) from a G1/2 temperature relief valve is 9.0m.

Subtract the resistance for 4 No. 22mm elbows at 0.8m each = 3.2m

Therefore the permitted length equates to: 5.8m

5.8m is less than the actual length of 7m therefore calculate the next largest size.

Maximum resistance allowed for a straight length of 28mm pipe (D2) from a G1/2 temperature relief valves equates to 18m.

Subtract the resistance of 4 No. 28mm elbows at 1.0m each = 4.0m

Therefore the maximum permitted length equates to: 14m

As the actual length is 7m, a 28mm (D2) copper pipe will be satisfactory.

Valve Outlet Size	Minimum Size Of Discharge Pipe D1	Minimum Size Of Discharge Pipe D2 From Tundish	Maximum Resistance Allowed, Expressed As A Length Of Straight Pipe (I.E. No Elbows Or Bends)	Resistance Created By Each Elbow Or Bend
G1/2	15mm	22mm 28mm 35mm	up to 9m up to 18m up to 27m	0.8m 1.0m 1.4m
G3/4	22mm	28mm 35mm 42mm	up to 9m up to 18m up to 27m	1.0m 1.4m 1.7m
G1	28mm	35mm 42mm 54mm	up to 9m up to 18m up to 27m	1.4m 1.7m 2.3m

Table 4: Sizing of copper discharge pipe (D2) for common temperature relief valve outlet sizes

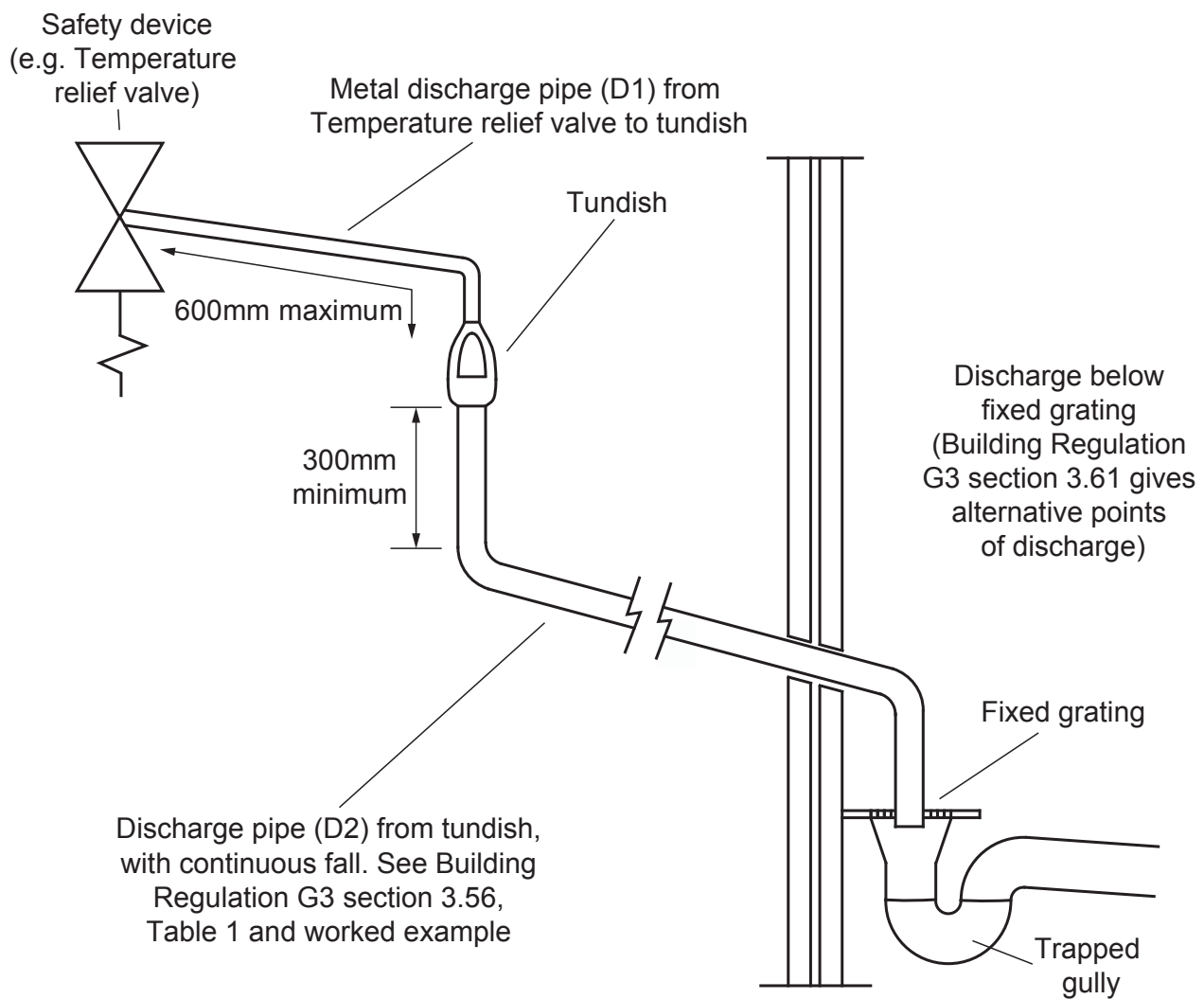

Figure 11: Typical discharge pipe arrangement (extract from Building Regulation G3 Guidance Section 3.50)

6.3 Electrical connections



WARNING

- ▶ Disconnect from the mains electrical supply before removing any covers.
- ▶ Never attempt to replace the immersion heater other than with genuine manufacturers components. Using other manufacturers components may invalidate the warranty on the cylinder.
- ▶ DO NOT bypass the thermal cut-out(s) in any circumstances.
- ▶ All electrical wiring should be carried out by a competent electrician and be in accordance with the latest I.E.E Wiring Regulations.
- ▶ Each circuit must be protected by a suitable fuse and double pole isolating switch with a contact separation of at least 3mm in both poles.
- ▶ DO NOT operate the immersion heaters until the appliance has been filled with water.

In case of difficulty contact service support; contact details are available on page 40 of this booklet.

Space and heating systems controls

- ▶ The controls provided with the appliance will ensure the safe operation of the unit within the central heating system.
- ▶ Connections to the various system components are made via the wiring centre fitted to the front of the appliance. The terminal identification labels within the wiring centre will aid in connecting the various external system components such as the mains supply, programmer and boiler.

Programmers and room temperature sensor

- ▶ The programmers and room temperature sensor are supplied loose such that they can be installed at a convenient location within the property.
- ▶ These items are supplied with their own installation and user instruction leaflet which should be referred to for details of mounting, wiring and programming.
- ▶ Room Temperature setting for zone 1 is done at the programmer, there is no adjustment at the room temperature sensor.
- ▶ Room temperature setting for zone 2 is done at the programmable room thermostat.



CAUTION

The room sensor is wired directly to the programmer, not to the wiring centre.

Basic programmer features:-

- ▶ 24 hour or 5/2 day operation.
- ▶ Room temperature setting at programmer.
- ▶ Set temperature over-ride facility.
- ▶ 1 hour hot water boost facility.
- ▶ Battery back up retains programmed information in the event of a power interruption.
- ▶ Low temperature set back option for periods when the property is unoccupied, eg. holiday periods.
- ▶ Independent time control of central heating and domestic hot water (Building Regulation Part L1 compliant).

Back up immersion heater

- ▶ The back up immersion heater should be wired in accordance with fig 13 and 14, page 18.
- ▶ The immersion heater thermostat is factory set at 57°C. This is set for eco mode, To maximise water availability the thermostat should be set to maximum during commissioning (see Fig 16 page 20). Should this require adjustment see Fig 16 for details of how to adjust the temperature setting. Each immersion heater has its own individual thermostatic control. The thermostat incorporates a thermal cut-out that will switch off the immersion heater in the event of a thermostat failure. The thermal cut-out reset button position is also shown on Fig 16 page 20.



WARNING

Should the Megaflo be used in conjunction with a boiler or external controls that control the water temperature via a sensor connected to the cylinder, it should be noted that the factory fitted indirect thermostat and thermal cut-out MUST NOT be disconnected or bypassed. To do so would invalidate the product approvals and warranty and it would not comply with Building Regulations. Should this method of control be adopted the Megaflo Indirect thermostat should be set at maximum and the cylinder control temperature set at 68°C to avoid the thermostat over-riding the boiler control. Where the boiler or external controls do not directly power the 2 Port Motorised Valve supplied with the Megaflo, the wiring should ensure that in the event of the thermal cut-out on the Megaflo Indirect controls operating power will be interrupted to the 2 Port Motorised Valve such that it closes and prevents flow of the primary heating fluid around the Megaflo primary heat exchanger coil.

For further details of wiring the boiler, or external controls consult the manufacturer's installation instructions.

6.4 Access to Appliance Control Housing

Removing the Control Housing Cover, (see fig 12)

- ▶ Unscrew the large screw using a flat ended screw driver.
- ▶ Lift from bottom of cover at point indicated until cover comes away freely

Replacing the Control Housing Cover, (see fig 12)

- ▶ Tilt and align the top 2 lugs in the holes indicated.
- ▶ Firmly press the cover until it "snaps" back in place.
- ▶ Tighten the large screw.

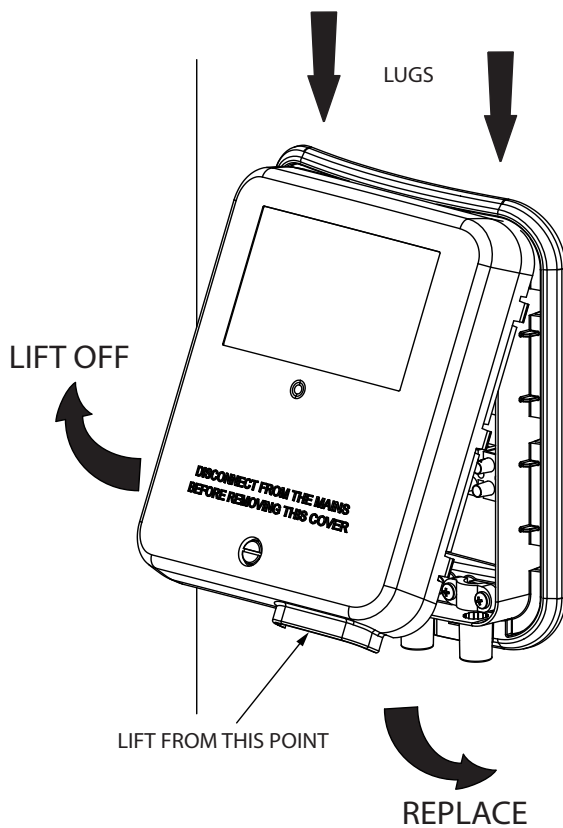
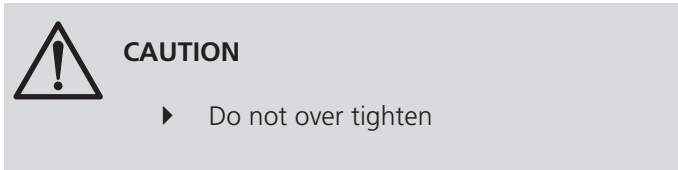

Figure 12: Housing Access

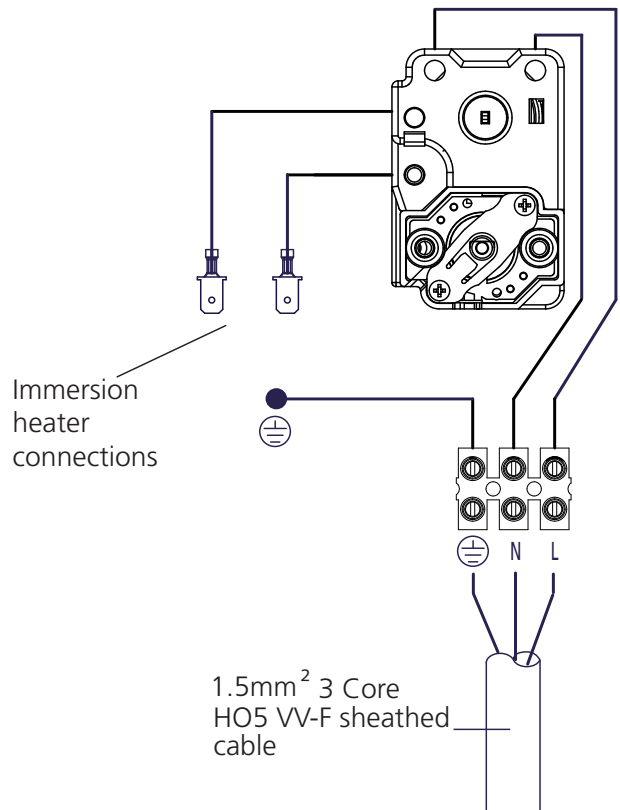

Figure 13: Direct wiring schematic

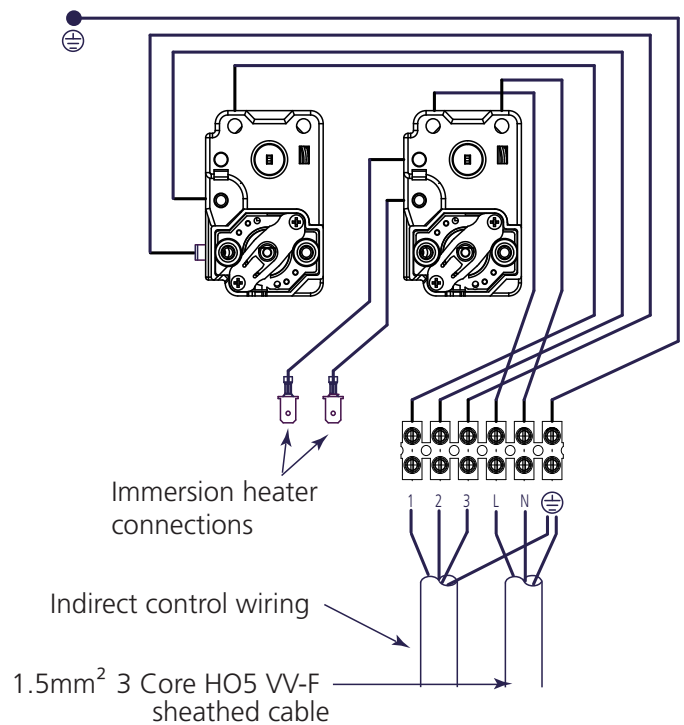
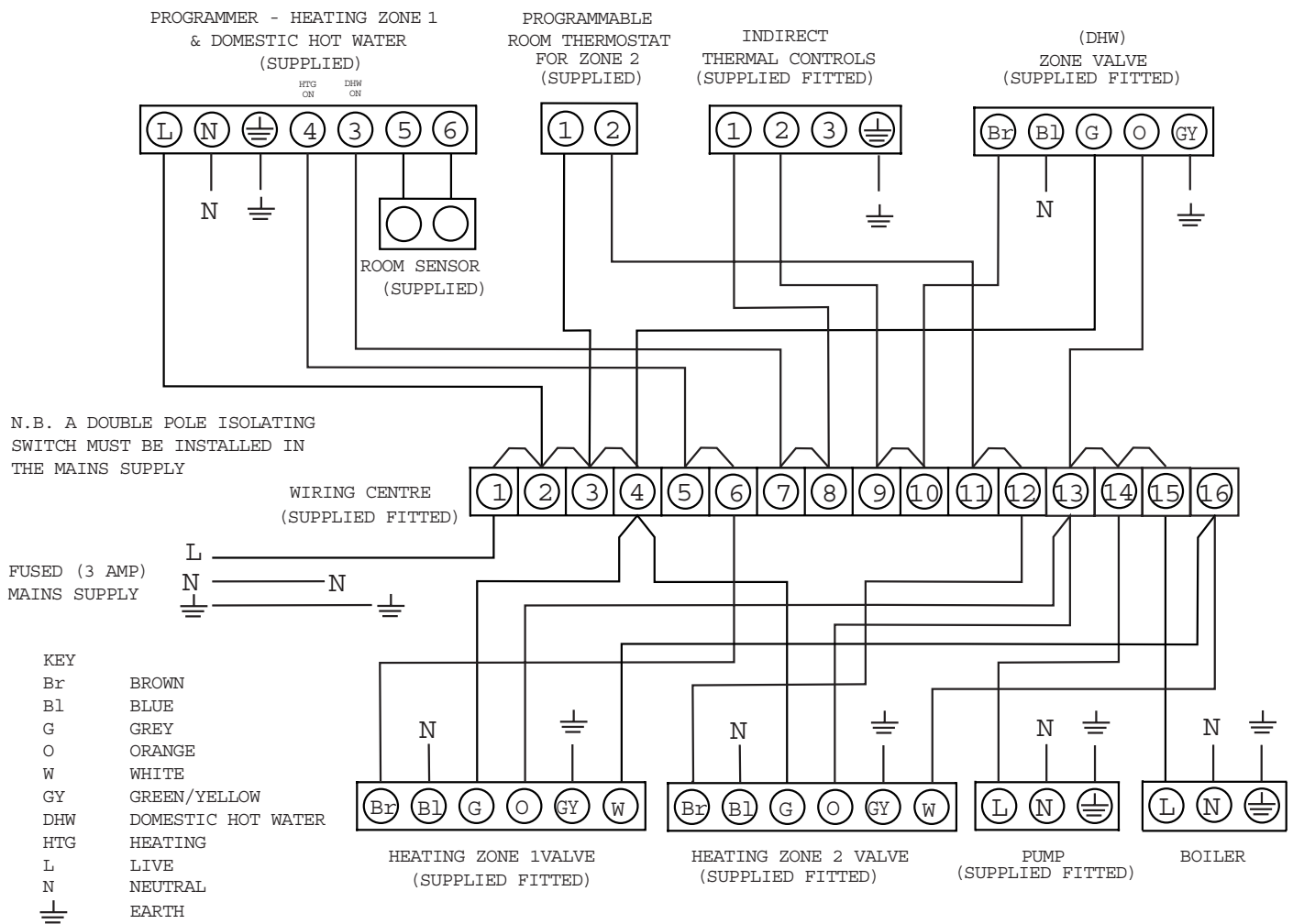

Figure 14: Indirect wiring schematic



NOTES

1. ALL EARTH CONNECTIONS MUST BE LINKED BACK TO THE EARTH TERMINALS IN THE WIRING CENTRE
2. ALL NEUTRAL CONNECTIONS MUST BE LINKED BACK TO THE NEUTRAL TERMINALS IN THE WIRING CENTRE
3. ASSUMES BASIC BOILER
4. THE 22MM MOTORISED VALVES DO NOT HAVE A WHITE WIRE

Figure 15: Schematic wiring diagram - basic 3 x 2 port valve system

6.5 Filling the appliance

- ▶ Ensure the drain cock is CLOSED.
- ▶ Open a hot tap furthest from the appliance.
- ▶ Open the isolating valve on the 3 bar Pressure Reducing Valve by turning the blue handle on the stop cock (if fitted in this position) so that it lies parallel to the direction of flow. Open the mains stop cock to fill the unit. When water discharges from the tap, allow to run for a few minutes to thoroughly flush through any residue, dirt or swarf, then close the tap.
- ▶ Open successive hot taps to purge the system of air.

7. Commissioning

7.1 General

After filling the installation with water in the previous section please follow the following steps to complete the installation of the unit.



WARNING

DO NOT operate the immersion heaters or primary circuit until the appliance has been filled with water.

- ▶ Air can be vented from the primary heating coil by unscrewing the small dust cap on the auto air vent by half a turn.
- ▶ The primary system should be pressurised to the minimum pressure required by the boiler (usually 1 bar), the pressure gauge fitted should be used to ensure the correct system pressure is set.
- ▶ When full and pressurised, the filling loop isolating valves should be closed, the pipe disconnected and caps replaced. The levers on the motorised valves should be returned to the Auto position.
- ▶ Switch on the boiler, ensure the programmer is set to Hot Water and allow the cylinder to heat up to a normal working temperature (70°C recommended).

7.2 Checklist before commissioning

- ▶ Check all water connections for leaks and rectify as necessary.
- ▶ Turn off mains water supply.
- ▶ Remove the pressure reducing valve head work to access the strainer mesh, clean and re-fit.
- ▶ Turn the water supply back on.
- ▶ Manually open, for a few seconds, each relief valve in turn, checking that water is discharged and runs freely through the tundish and out at the discharge point. (see fig 7, page 11)
- ▶ Ensure that the valve(s) reseal satisfactorily.

Back UP Direct Heating

- ▶ Switch on electrical supply to the immersion heater(s) and allow the appliance to heat up to normal working temperature, factory set to 57°C but for maximum water availability reset to 70°C (see Fig 16 below).
- ▶ The adjustment represents a temperature range of 10°C to 70°C.
- ▶ Check the operation of thermostat and that no water has issued from the Expansion Relief Valve or Temperature/Pressure Relief Valve during the heating cycle.

7.3 Commissioning procedure

Indirect units

- ▶ Ensure the filling loop hose is connected at both ends and is tight.
- ▶ Open the isolating valves at either end of the filling loop and allow to fill from the mains inlet supply.
- ▶ Fill the indirect (primary) circuit following the boiler manufacturer's commissioning instructions.
- ▶ To ensure the appliance primary heat exchanger is filled, both of the 2 port motorised valve (supplied) should be manually opened by moving the lever on the motor housing to the MANUAL setting. When the primary circuit is full return the lever's to the AUTOMATIC position.



WARNING

- ▶ If the unit is to be left unused following installation and commissioning e.g. unoccupied properties, the water heater should be drained or regularly flushed through with fresh mains water once a week.
- ▶ When placing the unit into service, the procedure for filling the unit and the system checks above should be observed.

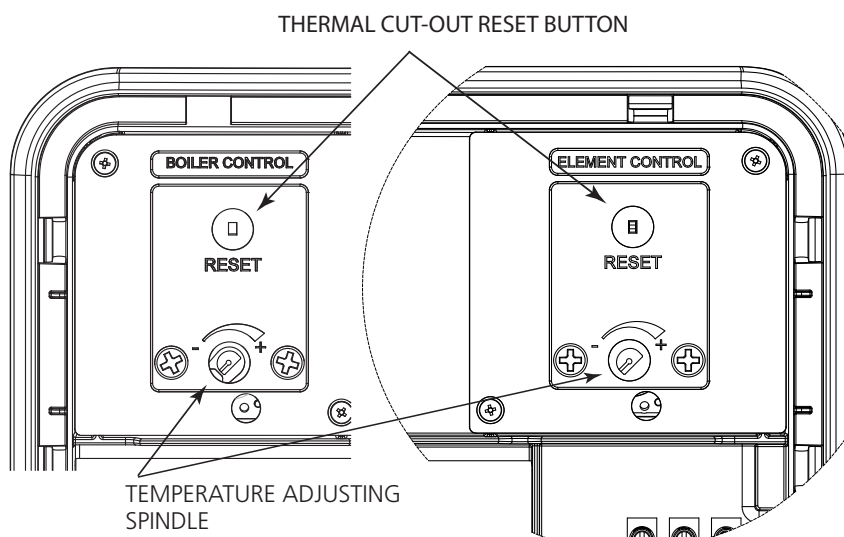

SPINDLE POSITIONS

☺ = MINIMUM TEMP

☹ = MAXIMUM TEMP

☺ = APPROX 60 °C

ROTATE SPINDLE CLOCKWISE FOR TEMPERATURE INCREASE AND COUNTER CLOCKWISE FOR TEMPERATURE DECREASE

Figure 16: Boiler and Immersion controls

7.4 Circulating pump set-up

Setting up the UPM3 pump

When you switch on the pump it will run to the pre-set position or the last setting. The diagram opposite shows the current operation status.

To change the pump setting, follow below:

- (a) Press the '⏸' to switch to the settings view. The LEDs show the current setting for 2 seconds.
- (b) Release '⏸' for more than 2 seconds. The user interface shows the current performance in "operation status".
- (c) Press '⏸' for more than 2 seconds and the circulator switches to "setting selection". The LEDs flash and show the current setting mode. Please note that if the key lock is disabled, the circulator will not switch to "setting selection". In this case, unlock the key lock by pressing the button for 10 seconds.
- (d) During a period of 10 seconds, press shortly on the '⏸' and the pump switches to the next setting.
- (e) To select between the settings, instantly press the button until you find the setting you want. If you pass the

setting, you will need to continue until the setting appears again. It is not possible to go back.

- (f) Release '⏸' for more than 10 seconds and the user interfaces switches back to the performance view and the last setting is stored.
- (g) Press '⏸' and the display switches to the setting view and the LEDs show the current setting for 2 seconds.
- (h) Release '⏸' for more than 2 seconds and the user interface switches back to the performance view.

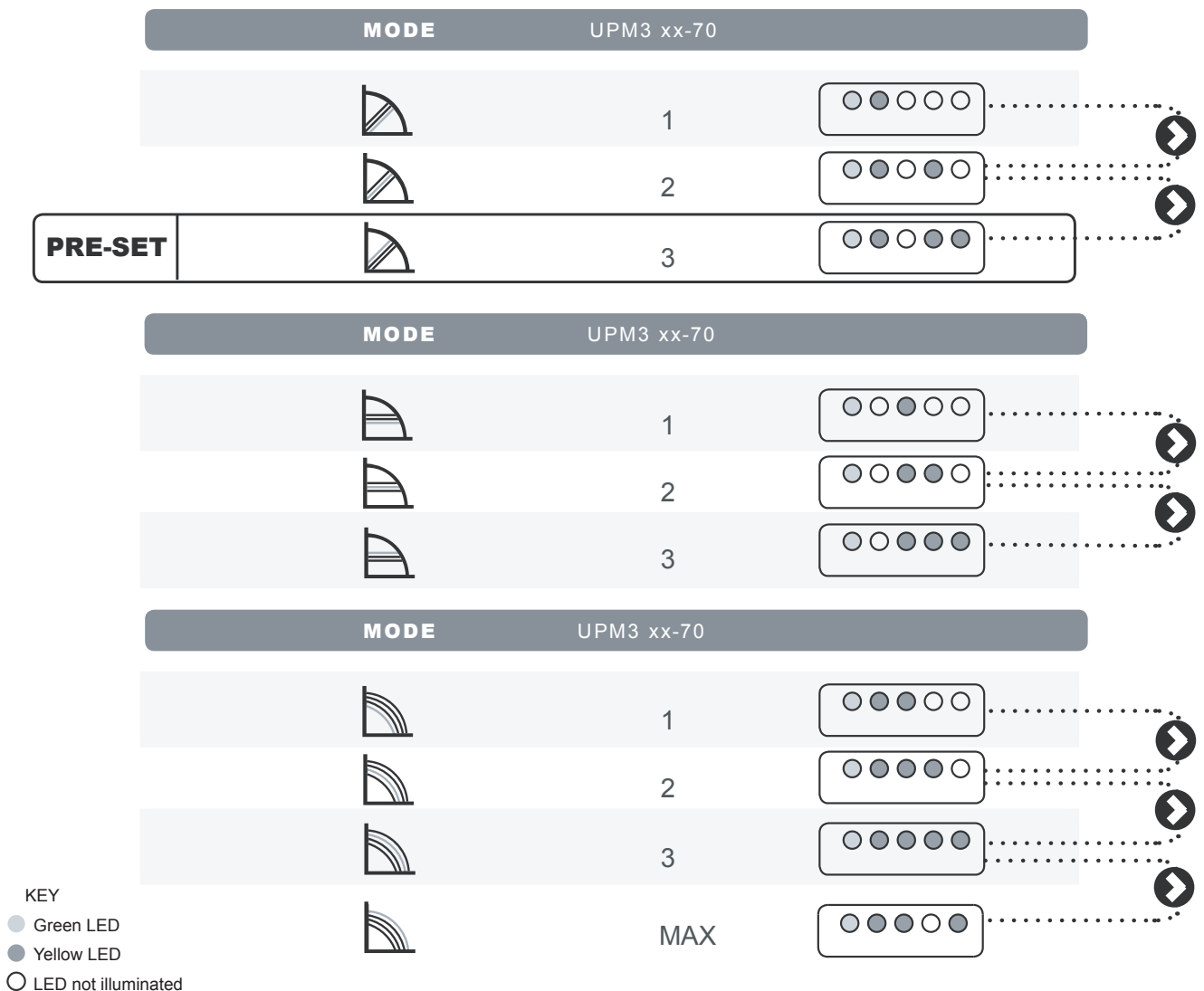

Control Mode explanation

Proportional pressure

The head pressure is reduced at falling heat demand and increased at rising heat demand. The duty point of the circulator will move up or down on the selected proportional pressure curve depending on the heat demand in the system.



- PP1: lowest proportional pressure curve



- PP2: Intermediate proportional pressure curve



- PP3: Highest proportional pressure curve

Constant pressure

The head pressure is kept constant, irrespective of the heat demand. The duty point of the circulator will move out or in on the selected constant pressure curve, depending on the heat demand in the system.



- CP1: lowest constant pressure curve



- CP2: Intermediate constant pressure curve



- CP3: Highest constant pressure curve

Constant curve

The circulator runs on a constant curve, which means that it runs at a constant speed or power.

The duty point of the circulator moves up or down the selected curve, depending on the heat demand in the system.



Constant Curve	
CC1	4 m
CC2	5 m
CC3	6 m
CC4 (max.)	7 m

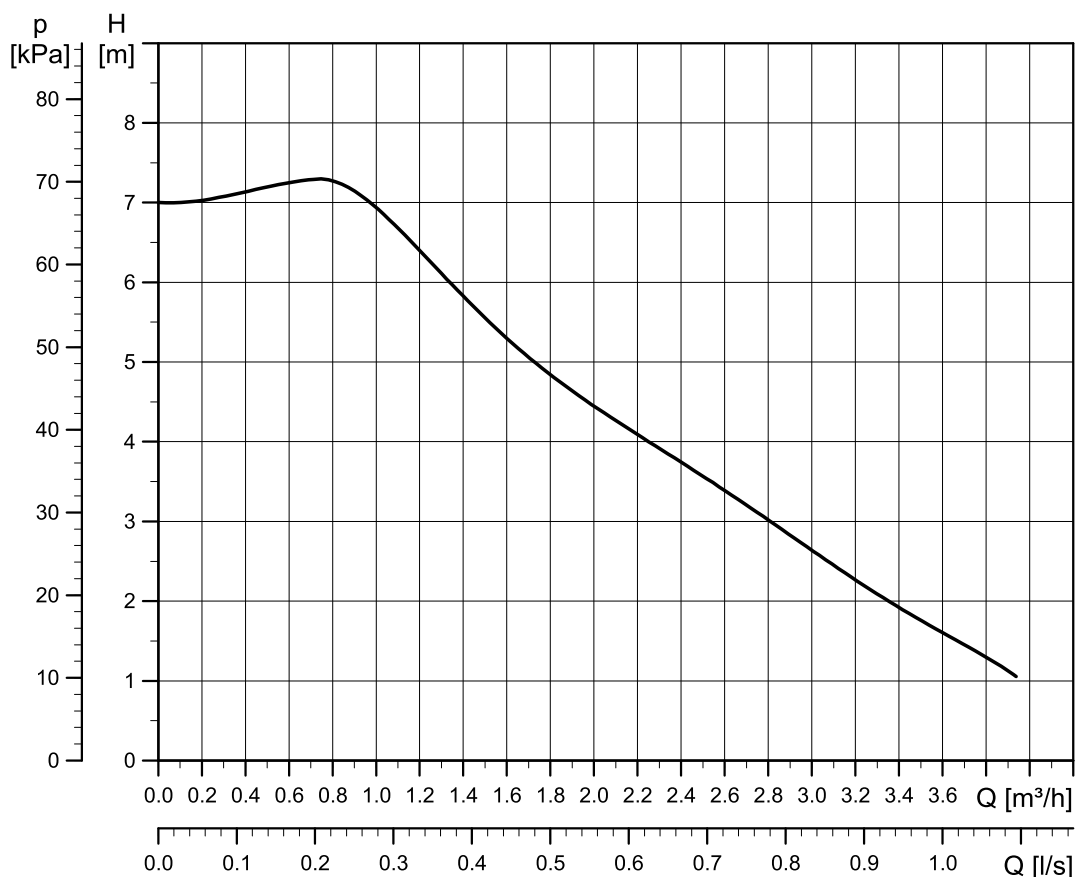

Benchmark

The appliance is covered by the Benchmark Scheme which aims to improve the standards of installation and commissioning of domestic heating and hot water systems in the UK and to encourage regular servicing to optimise safety, efficiency and performance.

Benchmark is managed and promoted by the Heating and Hotwater Industry Council. For more information visit www.centralheating.co.uk.

All installations must be notified to Local Area Building Control either directly or through a Competent Persons Scheme. A Building Regulations Compliance Certificate will then be issued to the customer who should, on receipt, write the Notification Number on the Benchmark Checklist.

This product should be serviced regularly to optimise its safety, efficiency and performance. The service engineer should complete the relevant Service Record on the Benchmark Checklist after each service.

The Benchmark Checklist may be required in the event of any warranty work.

8. Operation

8.1 General

WARNING



- ▶ If water discharges from the Temperature/Pressure Relief Valve on the cylinder shut down the heat source. Do not turn off any water supply. Contact a competent installer for unvented water heaters to check the system.
- ▶ Do not tamper with any of the safety valves fitted to the system. If a fault is suspected contact a competent installer.
- ▶ DO NOT bypass the thermal cut-out(s) in any circumstances.

Please ensure that the installer has fully completed the Benchmark Checklist (page 32) of this manual and that you have signed it to say that you have received a full and clear explanation of its operation. The installer is legally required to complete a commissioning checklist as a means of complying with the appropriate Building Regulations (England & Wales).

Flow performance

When initially opening hot outlets a small surge in flow may be noticed as pressures stabilise. This is quite normal with unvented systems. In some areas cloudiness may be noticed in the hot water. This is due to aeration of the water, is quite normal and will quickly clear.

Operational faults

Operational faults and their possible causes are detailed in the Fault Finding section (p.26) of this book. It is recommended that faults should be checked by a competent installer.

Temperature controls - indirect units

- ▶ A combined thermostat and thermal cut-out is provided for the control of the external boiler. The thermostat is factory set to give a water storage temperature of approx. 70°C, however it can be set to control between 10°C and 70°C. Adjustments can only be made by opening the controls covers.
- ▶ To access the thermostat open the controls housing cover (see Fig 12, page 18)- DISCONNECT THE ELECTRICAL SUPPLY BEFORE OPENING THE COVER(S).
- ▶ Temperature adjustment is made by rotating the adjustment spindle on the top of the thermostat. The adjustment represents a temperature range of 10°C to 70°C (see page 20, Fig 16 for method of adjustment).
- ▶ Maximum working temperature is 70°C.
- ▶ The boiler thermostat and thermal cut-out must be wired in series with the 2 port motorised zone valve supplied to interrupt the flow of primary water

around the heat exchanger coil when the control temperature has been reached.

- ▶ The controls fitted to the cylinder will affect the temperature of the stored water only, other controls will be provided in the system for time and temperature control of the space heating requirements. Consult the instructions provided with those controls for details of adjustments.

Temperature controls – Back up immersion heater

- ▶ The immersion heater is fitted with a thermostat which is fitted in the centre of the heater plate and a cut-out which is fitted to the side of the thermostat.
- ▶ Access to the thermostat can be made by opening the immersion heater cover - DISCONNECT THE ELECTRICAL SUPPLY BEFORE OPENING THE COVER.
- ▶ Temperature adjustment is made by rotating the adjustment knob on the top of the thermostat. The adjustment represents a temperature range of 10°C to 70°C.
- ▶ Maximum working temperature is 70°C. In very hard water areas limit to 60/65°C.

Expansion Volume

The air volume within the product will periodically require recharging to ensure expanded water is accommodated within the system. A discharge of water INTERMITTENTLY from the expansion valve will indicate the air volume has reduced to a point where it can no longer accommodate the expansion.



<http://www.baxi.co.uk/information-and-advice/how-to-videos.htm>

To recharge the air volume:-

- ▶ Turn off the heat source to the appliance via programmers / immersion isolation switch(es).
- ▶ Turn off the water supply to the appliance by turning off the isolating valve on the 3 bar pressure reducing valve if fitted at this point. Turn the handle so that it lies at 90° to the direction of flow.
- ▶ Open the lowest hot tap.
- ▶ Hold open the Temperature / Pressure Relief Valve until water ceases to run from the tap and gurgling noise at the valve stops, (see fig 7, page 11)
- ▶ Close the Temperature / Pressure Relief Valve.
- ▶ Turn on the isolating valve at the Pressure Reducing Valve by turning the handle so it lies parallel to the direction of flow, when water flows from the hot tap, close tap.
- ▶ The air volume will be automatically recharged as the unit refills. If after following the above actions water still discharges from the Expansion Relief Valve, further advice should be sought from a competent installer or the Megaflo service department.

9. Maintenance

9.1 General

Maintenance requirements

Unvented hot water systems have a continuing maintenance requirement in order to ensure safe working and optimum performance. It is essential that the relief valve(s) are periodically inspected and manually opened to ensure no blockage has occurred in the valves or discharge pipework. Maintenance of this appliance should only be carried out by a suitably qualified person. Failure to do so could invalidate the warranty.

Similarly cleaning of the strainer element and replacement of the air in the product will help to prevent possible operational faults.

The maintenance checks described below should be performed by a competent person on a regular basis, e.g. annually to coincide with boiler maintenance.

After any maintenance, please complete the relevant Service Interval Record section of the Benchmark Checklist on page 33 of this document.

9.2 Standard inspection & maintenance operation

Inspection

The immersion heater boss can be used as an access for inspecting the appliance internally.

Safety valve operation



WARNING

Water discharged may be very hot!

- ▶ Manually operate the Temperature/Pressure Relief Valve for a few seconds. (see fig 7, page 11)
- ▶ Check water is discharged and that it flows freely through the tundish and discharge pipework.
- ▶ Check valve reseats correctly when released.
- ▶ Repeat the above procedure for the Expansion Relief Valve. (see fig 7, page 11)

Strainer

- ▶ Turn off the isolating valve prior to the Pressure Reducing Valve or the main stop cock to the system.
- ▶ Open the lowest hot tap in the system to relieve the system pressure.
- ▶ Using a spanner unscrew the pressure reducing cartridge and remove the moulded housing. The strainer will be removed with the cartridge.
- ▶ Wash any particulate matter from the strainer under clean running water.
- ▶ Replace the strainer and screw the Pressure Reducing Valve cartridge into the moulded housing.
- ▶ Close hot tap, turn on isolating valve or main stop cock to the system. Check for leaks.

Descaling immersion heater(s)



CAUTION

DO NOT use a sharp implement to scrape off scale as damage to the element surface could be caused.

- ▶ Turn off the mains water supply, isolate the electrical supply and turn off boiler
- ▶ Attach a hosepipe to the drain cock having sufficient length to take water to a suitable discharge point below the level of the unit.
- ▶ Open a hot tap close to the unit and open drain cock to drain unit. If water fails to drain vent the unit manually by opening the Temperature and Pressure Relief Valve. There is no need to drain the primary circuit
- ▶ Open the cover to the immersion heater housing and disconnect wiring from immersion heater thermostat.
- ▶ Unscrew the immersion heater backnut and withdraw the immersion heater from the appliance. A key spanner is supplied with the product for easy removal and tightening of the immersion heater. Over time the immersion heater gasket may become stuck to the mating surface. To break the seal insert a round shafted screwdriver into one of the pockets on the immersion heater and gently lever up and down. Take care when lifting the immersion heater out of the cylinder and work within safe working practices.
- ▶ Carefully remove any scale from the surface of the element.
- ▶ Ensure sealing surfaces are clean and seals are undamaged, if in doubt fit a new gasket. (spare part number 70 351 65)
- ▶ Replace immersion heater, making sure not to trap the gasket.
- ▶ Rewire, check, close and secure immersion heater housing cover.

Re-commissioning

- ▶ Check all electrical and plumbing connections are secure. Close the drain cock.
- ▶ With a hot tap open, turn on the cold water supply and allow unit to refill.
- ▶ DO NOT switch on the immersion heater or boiler until the unit is full.
- ▶ When water flows from the hot tap allow to flow for a short while to purge air and flush through any disturbed particles.
- ▶ Close hot tap and then open successive hot taps in system to purge any air.
- ▶ When completely full and purged check system for leaks.
- ▶ The heating source (immersion heater or boiler) can then be switched on.

10. Troubleshooting



WARNING

Do not tamper with any of the safety valves or controls supplied with the appliance as this will invalidate any warranty. Water contained in the appliance may be very hot, especially following a thermal control failure. Caution must be taken when drawing water from the appliance

The fault finding chart (table 5, below) will enable operational faults to be identified and their possible causes rectified. Any work carried out on the unvented water heater and its associated controls **MUST** be carried out by a competent installer for unvented water heating systems. In case of doubt contact service support.

Spare Parts

A full range of spare parts are available for the appliance range (table 6, page 28). Refer to the technical data label on the unit to identify the model installed and ensure the correct part is ordered. You will need to quote the serial number, which is printed on the data label.

10.1 Fault finding

Important

- ▶ After servicing, complete the relevant Service Interval Record section of the Benchmark Checklist located on pages 32 and 33 of this document.
- ▶ Servicing should only be carried out by competent persons in the installation and maintenance of unvented water heating systems.
- ▶ Any spare parts used **MUST** be authorised parts.
- ▶ Disconnect the electrical supply before removing any electrical equipment covers.
- ▶ **NEVER** bypass any thermal controls or operate system without the necessary safety valves.

Fault	Possible Cause	Remedy
No hot water flow	Mains water supply off	Check and open stop cock
	Strainer blocked	Turn off water supply. Remove strainer and clean
	Pressure Reducing Valve incorrectly fitted	Check and refit as required
Water from hot tap is cold	Indirect programmer set to central heating only	Check, set to domestic hot water programme
	Indirect boiler not working	Check boiler operation. If fault is suspected consult boiler manufacturer's instructions
	Indirect thermal cut-out has operated	Check, reset by pushing button on thermostat. Check operation of indirect thermostat
	Indirect motorised valve not connected correctly	Check wiring and/or plumbing connections to motorised valve
	Immersion heater not switched on	Check and switch on
	Immersion heater thermal cut-out has operated	Check, reset by pushing button on thermostat
Water discharges from Expansion Valve	Intermittently Air volume in product has reduced	See Page 24 for re-charging of the air volume
	Continually Pressure Reducing Valve failure. Expansion valve seat damaged	Check pressure from Pressure Reducing valve. If greater than 3bar replace Pressure Reducing Valve Fit new T&P/Expansion valve
Water discharges from T&P Relief Valve	Thermal control failure CAUTION: Water will be very hot!	Switch off power to immersion heater(s) and shut down boiler. DO NOT turn off water supply. When discharge stops check all thermal controls, replace if faulty
Milky water	Oxygenated water	Water from a pressurised system releases oxygen bubbles when flowing. The milkiness will disappear after a short while

Table 5: Fault finding chart

11. Decommissioning

11.1 Decommissioning procedure

- ▶ Isolate electrical supplies and make safe
- ▶ Isolate the water supply
- ▶ Drain the cylinder
- ▶ Drain the primary circuit (indirect only)
- ▶ Remove cylinder
- ▶ Cap pipework

Environmental information

Products are manufactured from many recyclable materials. At the end of their useful life they should be disposed of at a Local Authority Recycling Centre in order to realize the full environmental benefits.

Insulation is by means of an approved CFC/HCFC free polyurethane foam with an ozone depletion factor of zero.

WEEE Declaration

Disposal of Waste Equipment by Users in Private Households in the European Union.



This symbol on the product indicates that this product must not be disposed of with your other household waste. Instead, it is your responsibility to dispose of your waste equipment by handing it over to a designated collection point for the recycling of waste electrical equipment. The separate collection and recycling of your waste equipment at the time of disposal will help to conserve natural resources and ensure that it is recycled in a manner that protects human health and the environment. For more information about where you can drop off your waste equipment for recycling, please contact your local city office, your household waste disposal service or the company where this product was purchased

12. Spare parts

12.1 Spare parts list

A full range of spare parts are available for the appliance range. Refer to the Technical Data label on the unit to identify the model installed and ensure the correct part is ordered.

Item	DESCRIPTION	SPARES NUMBER
1	Cold water inlet control kit - Complete (NOT SHOWN)	70 316 91
2	3 bar Pressure reducing valve - Complete	95 605 886
3	Immersion heater gasket	70 351 65
4	Immersion heater key spanner (NOT SHOWN)	95 607 861
5	Immersion heater blanking plate (NOT SHOWN)	95 605 881
6	90° Tundish	70 342 07
7	T&P/ERV combination valve	70 347 96
8	Set of compression nuts and olives (NOT SHOWN)	95 607 838
9	Drain valve 1/4 turn	95 605 051
10	22mm Manifold	70 341 21
11	Direct combined thermostat / thermal cut-out	70 316 88
12	Wiring centre	95 612 702
13	Automatic differential bypass valve (straight)	95 607 692
14	Indirect element - Incoloy (Bent, lower)	95 606 984
15	Immersion heater backnut - Plastic (Black)	95 605 132
16	Indirect combined thermostat / thermal cut-out	70 316 89
17	Controls cover	70 316 73
18	Indirect mounting plate	95 607 931
19	6 way terminal block	95 607 933
20	2 port motorised valve (22mm compression connections)	95 605 819
21	1/2" BSP Sensor Pocket Assembly Long	70 325 79
22	Pressure gauge	95 607 065
23	Mixer valve (55°C) - Standard	70 373 07
24	Mixer valve (60°C) - Accessory	70 373 06
25	TP9000 Programmer (NOT SHOWN)	95 607 903
26	TP1 room temperature sensor (NOT SHOWN)	95 607 904
27	Danfoss programmable room stat (NOT SHOWN)	95 607 044
28	Automatic air vent (NOT SHOWN)	95 605 050
29	12 Litre primary expansion vessel (NOT SHOWN)	95 607 066
30	Expansion vessel hose (NOT SHOWN)	95 607 067
31	Circulating pump	70 328 42
32	Expansion relief valve (3 bar primary circuit) (NOT SHOWN)	95 607 095
33	Filling loop and connection	95 607 096

Table 6: Spares

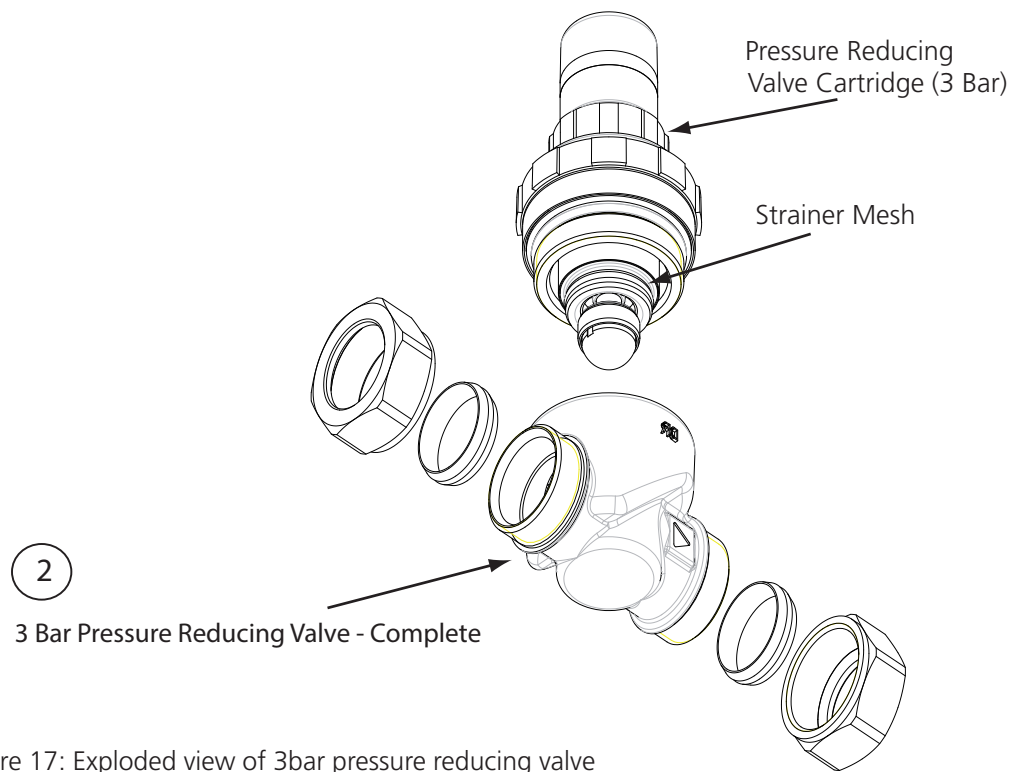

Figure 17: Exploded view of 3bar pressure reducing valve

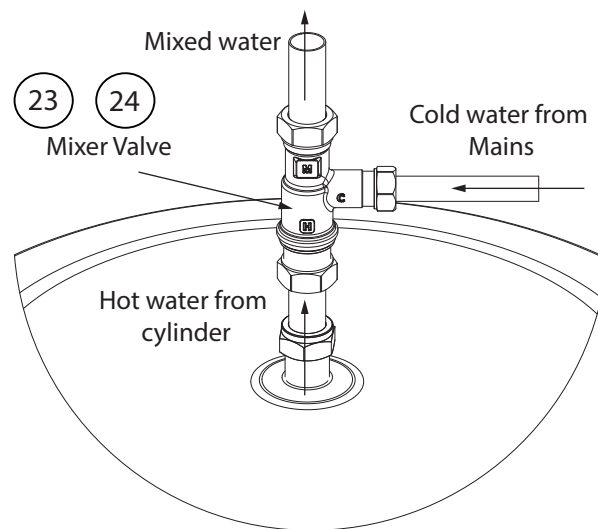

Figure 18: Mixing valve

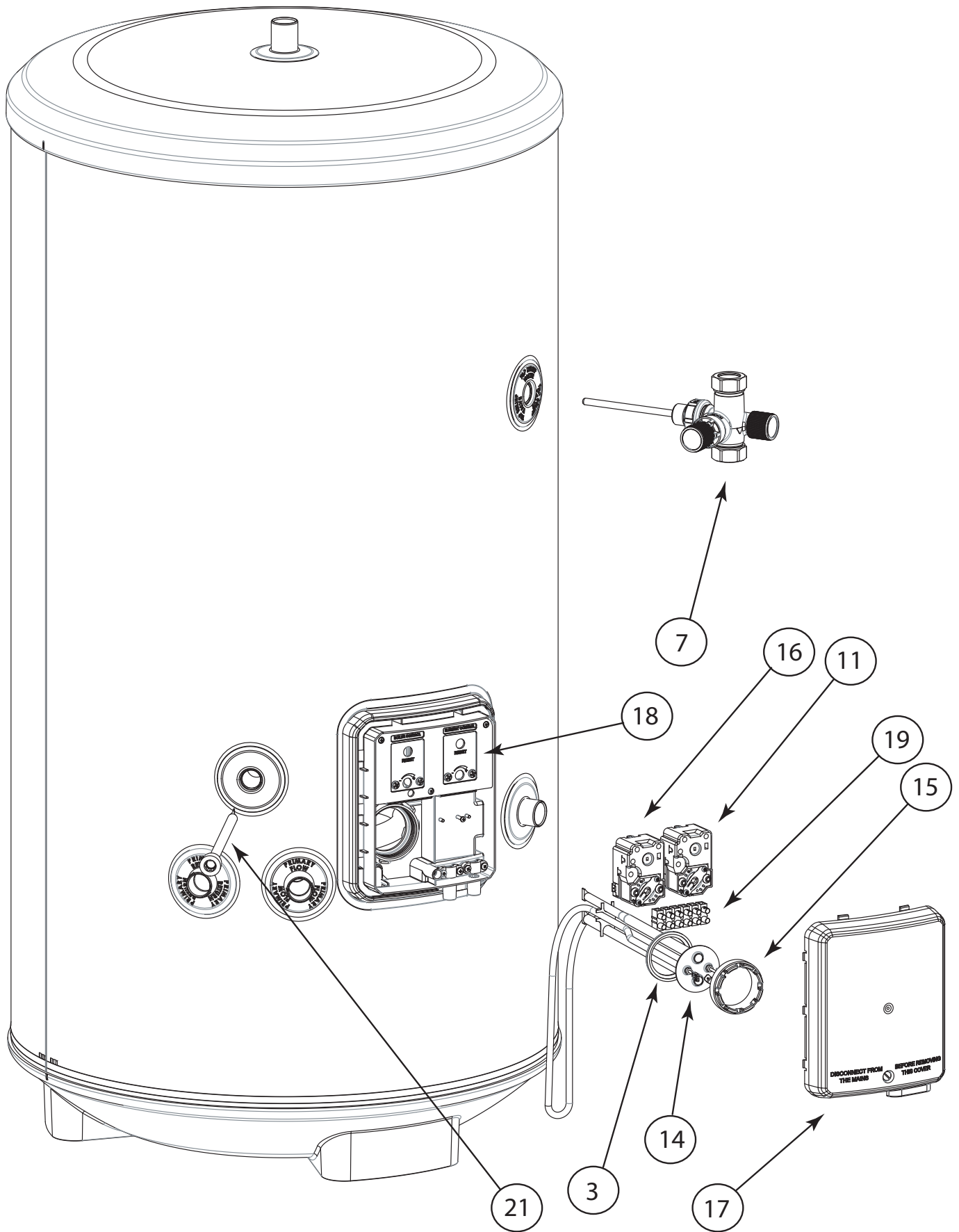

Figure 19: Indirect exploded view

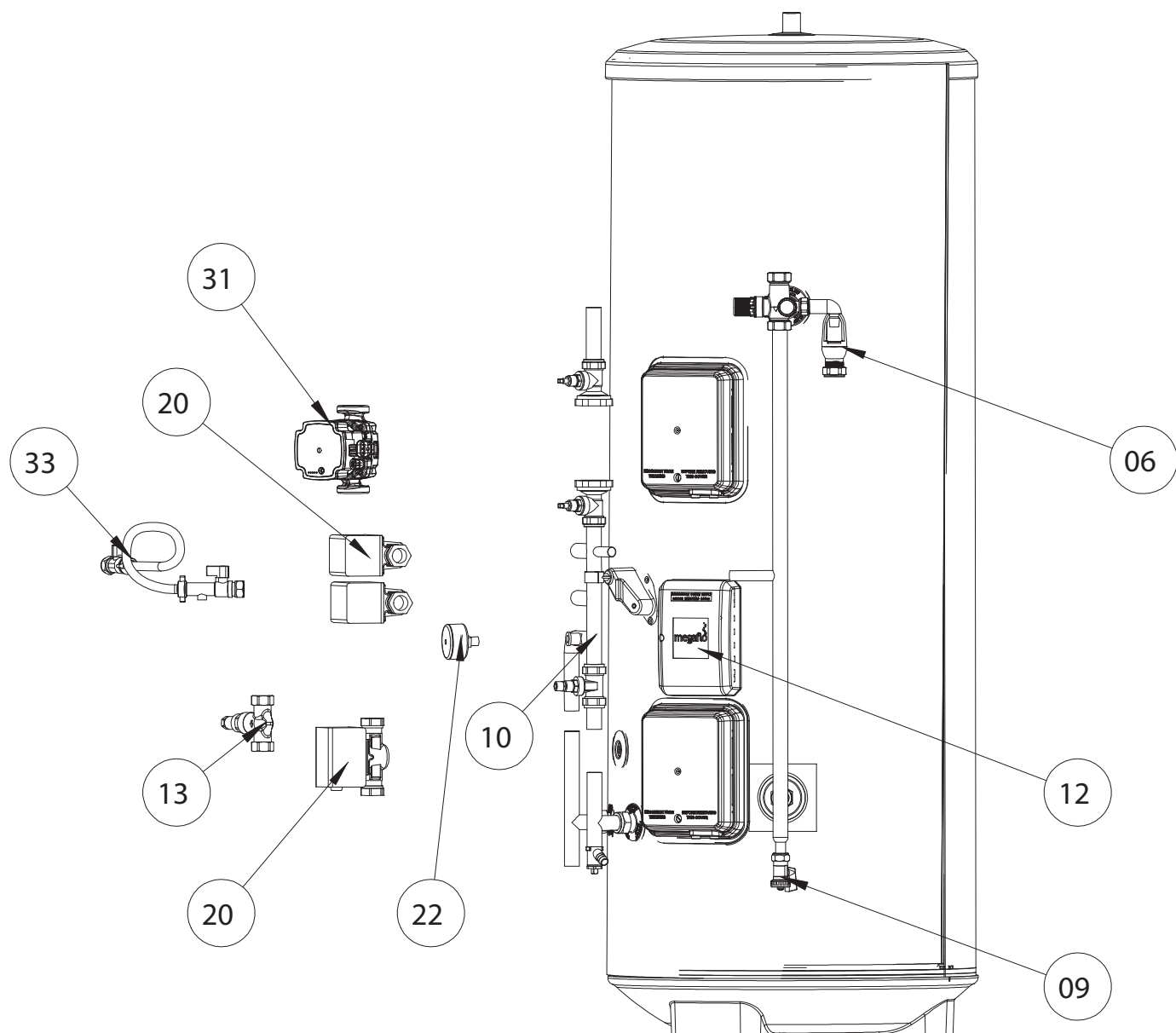

Figure 20: Indirect exploded view

SERVICE RECORD

It is recommended that your hot water system is serviced regularly and that the appropriate Service Record is completed.

Service Provider

Before completing the appropriate Service Record below, please ensure you have carried out the service as described in the manufacturer's instructions.

SERVICE 1

Date

Engineer Name

Company Name

Telephone Number

Comments

Signature

SERVICE 2

Date

Engineer Name

Company Name

Telephone Number

Comments

Signature

SERVICE 3

Date

Engineer Name

Company Name

Telephone Number

Comments

Signature

SERVICE 4

Date

Engineer Name

Company Name

Telephone Number

Comments

Signature

SERVICE 5

Date

Engineer Name

Company Name

Telephone Number

Comments

Signature

SERVICE 6

Date

Engineer Name

Company Name

Telephone Number

Comments

Signature

SERVICE 7

Date

Engineer Name

Company Name

Telephone Number

Comments

Signature

SERVICE 8

Date

Engineer Name

Company Name

Telephone Number

Comments

Signature

SERVICE 9

Date

Engineer Name

Company Name

Telephone Number

Comments

Signature

SERVICE 10

Date

Engineer Name

Company Name

Telephone Number

Comments

Signature

Warranty

The Megaflo Compact Warranty provides unrivalled levels of customer support and peace of mind in the unlikely event that a problem arises from a manufacturing defect. It is supported by a large nationwide team of company-employed field-based engineers and our own call centre, which is open 363 days a year.

The Megaflo Compact Warranty covers Megaflo Compact cylinders installed in domestic properties† against corrosion for 25 years from date of original purchase.

The cold water inlet valve (and expansion vessel, where supplied) is covered by a five year warranty from the date of purchase of the Megaflo Compact product, that includes both parts and labour. All other components, including any other valves, fittings and controls supplied with the Megaflo Compact are covered by a two year warranty from the date of purchase of the Megaflo Compact product, that includes both parts and labour.

In the case of the Megaflo Compact Systemready, Megaflo Compact Systemfit appliances, the supplied pumps and motorized valves (where fitted) are also covered by this two year warranty.

Incoloy immersion heaters are covered by a two year warranty.

Outside of the UK

These warranties are valid for installations within the United Kingdom.

For installation in the Republic of Ireland please contact Baxi Potterton Myson (Ireland) Limited on 00353 (0) 1 4590870

For installations outside of the United Kingdom and the Republic of Ireland, please telephone Megaflo Export on +44 1603 420271 for further details of the warranty terms and conditions applicable.

This warranty is valid provided that:

- The Megaflo Compact product has been installed by a competent installer in accordance with the instructions contained in the installation instructions and in compliance with all relevant laws, guidance, codes of practice and regulations in force at the time of installation.
- The Megaflo Compact product has not been modified or tampered with in any way, other than by a Baxi Customer Support approved engineer.
- The Megaflo Compact product has not been subject to damage by scale.
- The Megaflo Compact product and any part or parts of the Megaflo product (whether factory fitted or otherwise) have not been repaired or replaced other than by a Baxi Customer Support approved engineer and any replacement parts used on the Megaflo Compact product are authorised Megaflo Compact spare parts.
- The factory fitted Temperature /Pressure & Expansion Relief Valve has not been tampered with or removed.
- The Megaflo Compact product has not been subject to misuse or neglect.

- The Megaflo Compact product has only been used for the storage of wholesome water. Should another substance be put through the product, the warranty will be invalid unless it is part of a disinfectant procedure carried out in accordance with BS EN 806.

- The Megaflo Compact product has not been subjected to frost or freezing temperatures.

- The Benchmark™ commissioning checklist service record, included in the Megaflo Compact installation instructions has been completed.

- Regular maintenance has been carried in accordance with the requirements set out in the maintenance section of the installation instructions, by a competent person, an approved engineer from Heatrae Sadia or any other part of the Baxi Groups Customer Support approved engineering team.

- Access is available, at reasonable times and upon reasonable notice, to the Megaflo Compact product to allow for any inspection repair or replacement.

- The product is registered within 60 days of purchase. This can be done by telephone, online or by using the registration form provided with the product.

- Evidence of purchase (for example a receipt or delivery note) and date of supply is submitted when making a claim.

- The Megaflo Compact product has not been affected by any cause beyond our reasonable control including, without limitation: an act of God, explosion, flood, fire or accident; war or civil disturbance; strike, industrial action or stoppages of work; any form of government intervention; a third party act or omission including theft or malicious damage; failure by you to give us a correct delivery address or notify us of any change of address.

If any of the following situations occur, the Megaflo Compact Warranty will NOT apply:

- Any wilful or accidental damage caused by your negligence
- Damage caused as a result of scale.
- Installation not in line with the installer and user manuals provided,
- Failure to comply with installation instructions (whether oral or in writing),
- Misuse of the Megaflo Compact product or alteration of the Megaflo product not in accordance with the requirements set out above.
- Defects which are reported to us outside of the warranty period on 0344 8711535 or Megafloservice@baxi.co.uk

- Any third party repair or replacement costs unless those costs have been agreed and authorised by Baxi Customer Support or Heatrae Sadia in writing prior to incurring the costs.

Claims

Defects should be reported to us as soon as you are aware of them. Please report defect to us by contacting 0344 871 1535 or Megaflservice@baxi.co.uk.

Notes

Heatrae Sadia accepts no liability for any third party damage.

These warranties do not affect your statutory rights and remedies in relation to the Megaflo Compact products.

Annual service

Annual services are available from Baxi Customer Support, the service division of Heatrae Sadia.

Please contact Baxi Customer Support on 0344 871 1535 for details.

Megaflo Compact 25 year warranty is the period during which the first owner of the Megaflo Compact or a new build home continues to own the property. Should the property be sold, the new owner and any subsequent owners will receive a 25 year warranty from the date the original owner purchased the Megaflo Compact or a new home with a Megaflo Compact installed.

The Megaflo Compact warranty is conditional on the installation being carried out in accordance with the installation instructions supplied with the product. These warranties do not affect your statutory rights. Full terms and conditions of these warranty packages are available on request or via www.heatraesadia.com/Megaflo

Megaflo may introduce modifications to their products from time to time. Consequentially the details given in this brochure are subject to alteration without notice.

Contacts

Specification Advice Hotline

T: 01603 420220

F: 01603 420229

E: specifier@heatraesadia.com

www.heatraesadia.com

Heatrae Sadia*, Hurricane Way, Norwich, Norfolk, NR6 6EA

* Heatrae Sadia is a trading name of Baxi Heating UK Limited, Brooks House, Coventry Road, Warwick, CV34 4LL

Spares Stockists

Electric Water Heating Co.
2 Horsecroft Place
Pinnacles
Harlow
Essex CM19 5BT
Tel: 0845 0553811
E-Mail: sales@ewh.co.uk

SPD
Special Product Division
Units 9 & 10
Hexagon Business Centre
Springfield Road
Hayes
Middlesex UB4 0TY
Tel: 020 8606 3567

Parts Center
Tel: 0344 292 7057
www.partscenter.co.uk

Newey & Eyre
Unit 3-5 Wassage Way
Hampton Lovett Ind. Estate
Droitwich, Worcestershire
WR9 0NX
Tel: 01905 791500
Fax: 01905 791501

UK Spares Ltd
Unit 1155
Aztec West
Almondsbury
Bristol BS32 4TF
Tel: 01454 620500

Alternatively contact your local supplying merchant
or wholesale branch or use our online stockist
finder
at www.interpartspares.co.uk

NOTES.

NOTES.



Customer service

Telephone: 0344 8711535

Facsimile: 0344 8711528

E-mail: megafloservice@baxi.co.uk

Megaflo
Hurricane Way
Norwich
Norfolk
NR6 6EA

Important notice to installations outside of the UK.

References to legislation, legal requirements, regulations, building regulations benchmark, spares stockists, guarantees and warranty are ONLY APPLICABLE WITHIN THE UK.

For local legislation, legal requirements, regulations, building regulations outside of the UK, contact your local Authority.

For spares stockists, guarantees and warranty outside the UK, contact your local supplier or,

Export Sales

T: +44 (0)1603 420271

F: +44 (0)1603 420199

E: export.sales@heatraesadia.com



The HWA Charter's Code of Practice requires that all members adhere to the following:

- To supply fit for purpose products clearly and honestly described
- To supply products that meet, or exceed appropriate standards and building and water regulations
- To provide pre and post sales technical support
- To provide clear and concise warranty details to customers



BY **HEATRAESADIA**

© 2016