

HEATRAESADIA

SMARTER | CLEANER | WARMER

Supreme Technical Data

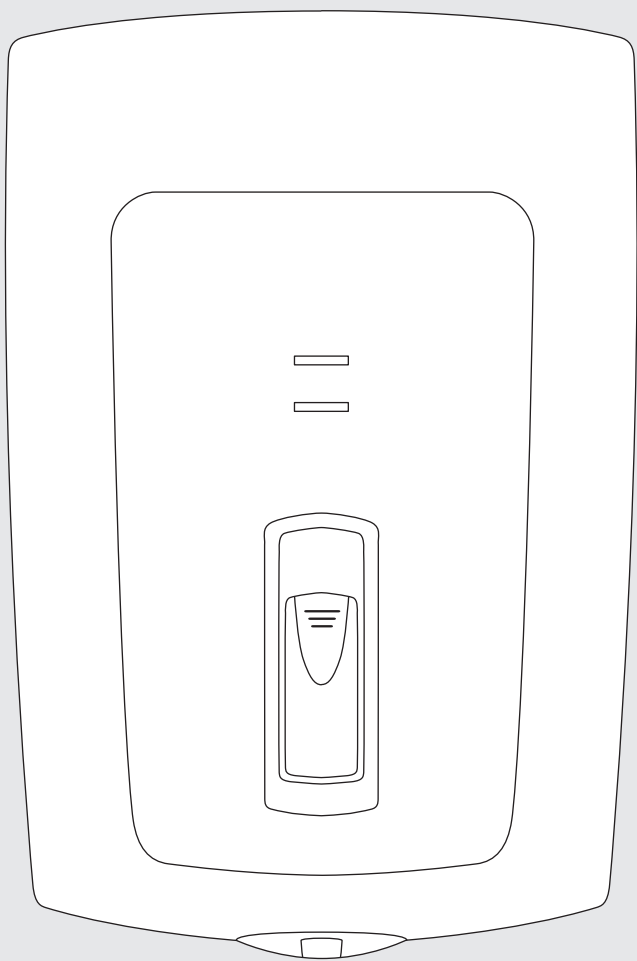

Supreme Components

Supreme 150, 165, 180 check list

- Wall mounting bracket.
- no. 12 x 2" screws (2 off).
- no. 8 x 1" screw (1 off).
- no. 12 x 2" wall plug (2 off).
- no. 8 x 1" wall plug (1 off).
- 15mm x 15mm straight push-fit connector.
- 15mm x 15mm 90°C elbow push fit connector.

Supreme 150SS, 165SS, 180SS check list

- Wall mounting bracket.
- no. 12 x 2" screws (2 off).
- no. 8 x 1" screw (1 off).
- no. 12 x 2" wall plug (2 off).
- no. 8 x 1" wall plug (1 off).
- 15mm x 15mm straight push-fit connector.
- 15mm x 15mm 90°C elbow push fit connector.

Supreme 220SS, 250SS, 310SS, 560SS check list

- Wall mounting bracket (hinged, 2 parts).
- M10 x 20mm set screws (2 off).
- no. 12 x 2" screws (3 off).
- no. 8 x 1" screw (2 off).
- no. 12 x 2" wall plug (3 off).
- 15mm x 15mm straight push-fit connector.
- 15mm x 15mm 90°C elbow push fit connector.
- Slotted case bracket (2 off).
- Case anchor strap.
- Stabilisers (2 off).
- Template.
- Tap.

Supreme Counter Top check list

- Flexible water inlet hose.
- Drip tray.
- User instructions.
- Warranty card.

Supreme

Specification

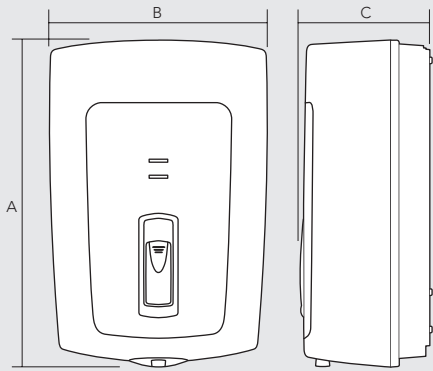

Supreme 150 / 165 / 180 White

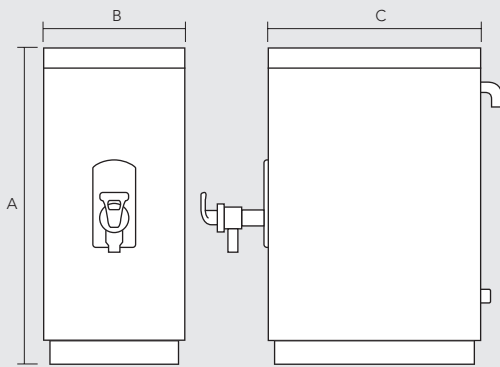

Supreme Counter Top

DIMENSIONS AND PERFORMANCE

Model	Supreme 150 White	Supreme 165 White	Supreme 180 White
A - Height (mm)	445	510	510
B - Width (mm)	290	335	335
C - Depth (mm)	190	200	262
Product Code	95:200:252	95:200:253	95:200:254
Weight (kg empty)	5.6	6.9	7.9
Capacity (litres)	2.5	5	7.5
Minimum operating pressure (bar)	0.5	0.5	0.5
Maximum operating pressure (bar)	10	10	10
Element rating @240V	2.5	2.5	2.5
Rated pressure (bar)	0	0	0
Minimum supply pressure (bar)	0.5	0.5	0.5
Maximum supply pressure (bar)	10	10	10

Model	Supreme Counter Top
A - Height (mm)	535
B - Width (mm)	240
C - Depth (mm)	360
Product Code	95:200:264
Weight (kg empty)	12
Capacity (litres)	9
Minimum operating pressure (bar)	0.2
Maximum operating pressure (bar)	10
Element rating @240V	3
Rated pressure (bar)	0
Minimum supply pressure (bar)	0.2
Maximum supply pressure (bar)	10

Supreme

Specification

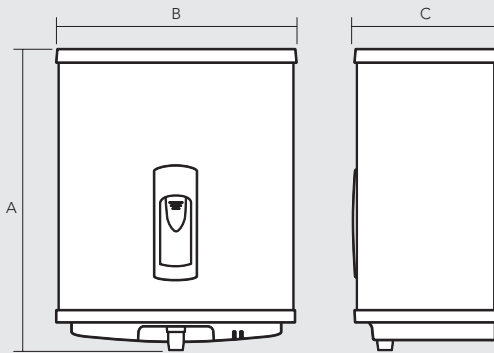

Supreme 150SS / 165SS / 180SS

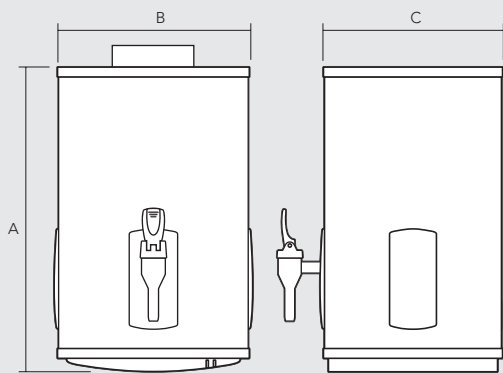

Supreme 220SS / 250SS / 310SS / 560SS

DIMENSIONS AND PERFORMANCE

Model	Supreme 150SS	Supreme 165SS	Supreme 180SS
A - Height (mm)	423	501	506
B - Width (mm)	337	337	337
C - Depth (mm)	203	203	262
Product Code	95:200:240	95:200:241	95:200:242
Weight (kg empty)	6.4	7.3	8.3
Capacity (litres)	2.5	5	7.5
Minimum operating pressure (bar)	0.5	0.5	0.5
Maximum operating pressure (bar)	10	10	10
Element rating @240V	2.5	2.5	2.5
Rated pressure (bar)	0	0	0
Minimum supply pressure (bar)	0.5	0.5	0.5
Maximum supply pressure (bar)	10	10	10

Model	Supreme 220SS	Supreme 250SS	Supreme 310SS	Supreme 560SS
A - Height (mm)	585	655	795	1000
B - Width (mm)	397	397	397	397
C - Depth (mm)	366	366	366	366
Product Code	95:200:243	95:200:244	95:200:245	95:200:246
Weight (kg empty)	21	22	26	31
Capacity (litres)	10	15	25	40
Minimum operating pressure (bar)	0.5	0.5	0.5	0.5
Maximum operating pressure (bar)	10	10	10	10
Element rating @240V	3	3	3	6
Rated pressure (bar)	0	0	0	0
Minimum supply pressure (bar)	0.5	0.5	0.5	0.5
Maximum supply pressure (bar)	10	10	10	10

Supreme

Specification

Installation requirements:

The Supreme stores and dispenses water close to or at boiling point, due caution must be taken when choosing a location for the product.

The Supreme is a vented water heater. The vent pipe must never be blocked or obstructed, it must be a minimum of 15mm outside diameter pipe (where the pipe length exceeds 3m the pipe diameter should increase).

Wherever possible the Supreme should be supplied directly from a rising main, if fed from a cold water feed cistern, the cistern must comply with the Water Regulations Guide. Note: water quality may be reduced when supplied from a cistern.

The Supreme must be vertically wall mounted using the bracket supplied (exc. Supreme Counter Top).

Sufficient room should be left around the heater to allow access for maintenance and servicing.

Ensure that the wall or counter top can support the full weight of the unit.

Water Supply:

Select appropriate push fit connector for chosen entry position (excluding Supreme Counter Top):

Bottom entry water –
15mm x 15mm 90°C elbow

Rear entry water –
15mm x 15mm straight.

NOTE: stainless or chromed pipes **DO NOT** provide secure connections with push fit fittings (use copper pipe at joints).

A WRAS listed isolating valve should be fitted to the cold supply to facilitate servicing the heater.

Electrical Requirements:

This appliance must be earthed.

The installation, supply cable and circuit protection must conform to the latest BS7671 'Requirements for electrical installations'.

The appliance must be connected to a 230 / 240V AC supply. A double pole isolating switch, with a contact separation of at least 3mm in both poles, incorporated in the electrical supply. The supply should be fused 13Amp.

If the Supreme is to be unused for significant periods of time running costs can be reduced by switching the unit off.

Fixing:

All Supreme products (exc. Supreme Counter Top) are supplied with hook-on brackets for wall mounting, ideally over a draining board or drip tray. Hinged mounting brackets on the large models allow unit to swing forward for ease of service access.

Maintenance:

The Supreme incorporates an electronic scale conditioning function which will reduce the rate of scale deposition in hard water areas. However, some deposits may still occur in the storage tank; these should be periodically removed.

The amount of usage of the unit will also determine the quantity of scale build up. A regular inspection of the tank every 6 to 12 months will provide longer life of the product and optimum performance.

Warranty:

The Supreme water heater is under warranty for a period of two years from the date of purchase.

The unit is not covered against damage by frost or due to the build-up of scale.

Environmental Information:

This product is manufactured from many recyclable materials. At the end of its useful life it should be disposed of at a Local Authority Recycling Centre.

Approvals:

BEAB Approved

DRINKING WATER SOLUTIONS

SPECIFICATION ADVICE HOTLINE

t | 01603 420220 e | specifier@heatraesadia.com

AFTER SALES SERVICE

t | 0344 871 1535 e | customer.support@heatraesadia.com

w | heatraesadia.com



Our nationwide network of Customer Support engineers

Heatrae Sadia has its very own dedicated nationwide network of highly trained customer support engineers so you can have peace of mind that we're always here to help.

PRODUCT RANGE

Full specification details on all our products are available to download from our website.

To support our corporate responsibility and sustainability charters and reduce our printed material, we encourage you to download product brochures from our website.

In designing these files we have taken into account the need to access data on screen.

If you would like to receive a printed copy of our full product catalogue please call our literature hotline on 01603 420127.

Heatrae Sadia may introduce modifications to their products from time to time. Consequently, the details given in this brochure are subject to alteration without notice.

Please follow us online:



Please recycle this product once you have finished with it.